



OFFERYNNAU STATUDOL
CYMRU

WELSH STATUTORY
INSTRUMENTS

2013 Rhif 2156 (Cy. 211)

2013 No. 2156 (W. 211)

**LLYWODRAETH LEOL,
CYMRU**

**LOCAL GOVERNMENT,
WALES**

**Gorchymyn Torfaen (Cymunedau)
2013**

**The Torfaen (Communities) Order
2013**

NODYN ESBONIADOL

(Nid yw'r nodyn hwn yn rhan o'r Gorchymyn)

EXPLANATORY NOTE

(This note is not part of the Order)

Mae'r Gorchymyn hwn, a wnaed yn unol ag adran 58(2) o Ddeddf Llywodraeth Leol 1972, yn rhoi effaith i gynigion y Comisiwn Ffiniau Llywodraeth Leol i Gymru ("y Comisiwn"), a hynny heb eu haddasu. Ym mis Ionawr 2013, cyflwynodd y Comisiwn adroddiad ar adolygiad a gynhaliwyd gan Gyngor Bwrdeistref Sirol Torfaen o ffiniau cymunedau ym Mwrdeistref Sirol Torfaen. Yn yr adroddiad, argymhellwyd newidiadau i nifer o ffiniau presennol.

This Order, made in accordance with section 58(2) of the Local Government Act 1972, gives effect without modification to proposals of the Local Government Boundary Commission for Wales ("the Commission"). The Commission reported in January 2013 on a review conducted by Torfaen County Borough Council of the community boundaries for the County Borough of Torfaen. The report recommended changes to a number of existing boundaries.

Effaith y Gorchymyn hwn yw bod newidiadau i nifer o ardaloedd cymunedol a rhai newidiadau canlyniadol i drefniadau etholiadol cynghorau cymuned. Mae newidiadau wedi eu gwneud i ffiniau Abersychan, Croesyceiliog, Cwmbrân Canolog, Fairwater, New Inn, Pen Tranch, Pontnewydd a Chwmbrân Uchaf. Mae wardiau cymunedol presennol Llanyrafon, sef Gogledd Llanyrafon a De Llanyrafon, wedi eu diddymu ac mae wardiau cymunedol newydd Dwyrain Llanyrafon a Gorllewin Llanyrafon wedi eu creu. Mae ward gymunedol newydd Thornhill wedi ei chreu. Mae newidiadau canlyniadol wedi eu gwneud i'r trefniadau etholiadol yn Sir Torfaen, gan gynnwys creu adrannau etholiadol newydd Dwyrain Llanyrafon a Phonthir, a Gorllewin Llanyrafon.

The effect of this Order is that there are changes to a number of community areas and some consequential changes in community council electoral arrangements. Changes are made to the boundaries of Abersychan, Croesyceiliog, Cwmbran Central, Fairwater, New Inn, Pen Tranch, Pontnewydd and Upper Cwmbran. The existing Llanyrafon community wards of Llanyrafon North and Llanyrafon South are abolished and the new community wards of Llanyrafon East and Llanyrafon West are created. The new community ward of Thornhill is created. Consequential changes are made to the electoral arrangements in the County of Torfaen, including the creation of the new electoral divisions of Llanyrafon East and Ponthir, and Llanyrafon West.

Mae printiau o fapiau 1 i 8 sy'n dangos y ffiniau ac y mae'r Gorchymyn hwn yn ymwneud â hwy wedi eu hadneuo a gellir edrych arnynt yn ystod oriau swyddfa arferol yn swyddfeydd Cyngor Bwrdeistref Sirol Torfaen, ac yn swyddfeydd Llywodraeth Cymru ym Mharc Cathays, Caerdydd, CF10 3NQ (yr Is-adran Llywodraeth Leol a Chymunedau).

Prints of the boundary maps 1 to 8 to which this Order relates are deposited and may be inspected during normal office hours at the offices of Torfaen County Borough Council, and at the offices of the Welsh Government at Cathays Park, Cardiff, CF10 3NQ (Local Government and Communities Division).

2013 Rhif 2156 (Cy. 211)

2013 No. 2156 (W. 211)

**LLYWODRAETH LEOL,
CYMRU**

**LOCAL GOVERNMENT,
WALES**

**Gorchymyn Torfaen (Cymunedau)
2013**

**The Torfaen (Communities) Order
2013**

Gwnaed

28 Awst 2013

Made

28 August 2013

Mae'r Comisiwn Ffiniau Llywodraeth Leol i Gymru wedi cyflwyno i Weinidogion Cymru, yn unol ag adrannau 54(1) a 58(1) o Ddeddf Llywodraeth Leol 1972(1), adroddiad dyddiedig Ionawr 2013 ar adolygiad a gynhaliwyd gan Gyngor Bwrdeistref Sirol Torfaen o'r ffiniau cymunedol yn Sir Torfaen, ynghyd â'r cynigion y mae'r Comisiwn wedi eu llunio ar y ffiniau cymunedol.

The Local Government Boundary Commission for Wales have submitted to the Welsh Ministers, in accordance with sections 54(1) and 58(1) of the Local Government Act 1972(1), a report dated January 2013 on a review carried out by Torfaen County Borough Council on the community boundaries for the County of Torfaen, together with the proposals the Commission have formulated on the community boundaries.

Mae Gweinidogion Cymru wedi penderfynu rhoi effaith i'r cynigion hynny heb eu haddasu.

The Welsh Ministers have decided to give effect to those proposals without modification.

Mae mwy na chwe wythnos wedi mynd heibio ers i'r cynigion hynny gael eu cyflwyno i Weinidogion Cymru.

More than six weeks have elapsed since those proposals were submitted to the Welsh Ministers.

Mae Gweinidogion Cymru yn gwneud y Gorchymyn a ganlyn drwy arfer y pwerau hynny a roddwyd i'r Ysgrifennydd Gwladol gan adran 58(2) o Ddeddf Llywodraeth Leol 1972 ac a freiniwyd bellach ynddynt hwy i'r graddau y maent yn arferadwy o ran Cymru(2).

The Welsh Ministers make the following Order in exercise of those powers conferred on the Secretary of State by section 58(2) of the Local Government Act 1972 and now vested in them so far as exercisable in relation to Wales(2).

-
- (1) 1972 p.70; diwygiwyd adran 54(1) gan baragraff 7(1) o Atodlen 15 i Ddeddf Llywodraeth Leol (Cymru) 1994 (p.19), paragraff 12 o Atodlen 3 i Ddeddf Llywodraeth Leol 1992 (p.19) ac adran 40(2) o Ddeddf yr Heddlu a Llysoedd Ynadon 1994 (p.29); diwygiwyd adran 58(1) gan baragraff 11(1) o Atodlen 15 i Ddeddf Llywodraeth Leol (Cymru) 1994 (p.19), ac adran 168(2) o Fesur Llywodraeth Leol (Cymru) 2011 (p.4).
- (2) Trosglwyddwyd pwerau'r Ysgrifennydd Gwladol i Gynulliad Cenedlaethol Cymru gan Orchymyn Cynulliad Cenedlaethol Cymru (Trosglwyddo Swyddogaethau) 1999 (O.S. 1999/672) ac fe'u breiniwyd bellach yng Ngweinidogion Cymru yn rhinwedd paragraff 30 o Atodlen 11 i Ddeddf Llywodraeth Cymru 2006 (p.32).

-
- (1) 1972 c.70; section 54(1) was amended by paragraph 7(1) of Schedule 15 to the Local Government (Wales) Act 1994 (c.19), paragraph 12 of Schedule 3 to the Local Government Act 1992 (c.19) and section 40(2) of the Police and Magistrates Court Act 1994 (c.29); section 58(1) was amended by paragraph 11(1) of Schedule 15 to the Local Government (Wales) Act 1994 (c.19), and section 168(2) of the Local Government (Wales) Measure 2011 (c.4).
- (2) The powers of the Secretary of State were transferred to the National Assembly for Wales by the National Assembly for Wales (Transfer of Functions) Order 1999 (S.I. 1999/672) and are now vested in the Welsh Ministers by virtue of paragraph 30 of Schedule 11 to the Government of Wales Act 2006 (c.32).

Enwi

1. Enw'r Gorchymyn hwn yw Gorchymyn Torfaen (Cymunedau) 2013.

Cychwyn

2.—(1) Yn ddarostyngedig i baragraff (2),

- (a) at bob diben a nodir yn rheoliad 4(1) o'r Rheoliadau, daw'r Gorchymyn hwn yn weithredol ar y diwrnod ar ôl diwrnod ei wneud;
- (b) at bob diben arall, daw'r Gorchymyn hwn yn weithredol ar 1 Ebrill 2014, sef y diwrnod penodedig at ddibenion y Rheoliadau.

(2) Daw erthyglau 5, 6 a 10 yn weithredol—

- (a) at ddiben trafodion sy'n rhagarweiniol i unrhyw etholiad i'w gynnal ar ddiwrnod arferol ethol cynghorwyr ar ôl i'r Gorchymyn hwn gael ei wneud, neu sy'n ymwneud ag etholiad o'r fath, ar 15 Hydref yn y flwyddyn cyn y diwrnod hwnnw;
- (b) at bob diben arall, ar ddiwrnod arferol ethol cynghorwyr a chynghorwyr cymuned ar ôl i'r Gorchymyn hwn gael ei wneud, sef y diwrnod penodedig at ddibenion y Rheoliadau ar gyfer erthyglau 6, 7 ac 11.

Dehongli

3. Yn y Gorchymyn hwn—

ystyr “newydd” (“*new*”), o ran ardal llywodraeth leol neu ardal etholiadol, yw'r ardal honno fel y'i sefydlir gan y Gorchymyn hwn;

ystyr “presennol” (“*existing*”), o ran ardal llywodraeth leol neu ardal etholiadol, yw'r ardal honno fel y mae'n bodoli yn union cyn y diwrnod penodedig;

ystyr “y Rheoliadau” (“*the Regulations*”) yw Rheoliadau Newidiadau yn Ardaloedd Llywodraeth Leol 1976(1);

mae unrhyw gyfeiriad at fap yn gyfeiriad at un o'r saith map a farciwyd “Map Gorchymyn Torfaen (Cymunedau) 2013”, a labelwyd yn briodol 1 i 8 er mwyn cyfeirio atynt ac a adneuwyd yn unol â rheoliad 5 o'r Rheoliadau;

mae unrhyw gyfeiriad at adran etholiadol yn gyfeiriad at adran etholiadol o Fwrdeistref Sirol Torfaen; ac

(1) O.S. 1976/246 (fel y'i diwygiwyd gan amryfal offerynnau statudol nad ydynt yn berthnasol i'r Gorchymyn hwn).

Title

1. The title of this Order is the Torfaen (Communities) Order 2013.

Commencement

2. —(1) Subject to paragraph (2),

- (a) for all purposes set out in regulation 4(1) of the Regulations, this Order comes into operation on the day after the day on which it is made;
- (b) for all other purposes, this Order comes into operation on 1 April 2014, which is the appointed day for the purpose of the Regulations.

(2) Articles 5, 6 and 10 come into operation—

- (a) for the purpose of proceedings preliminary or relating to any election to be held on the ordinary day of election of councillors following the making of this Order, on 15 October in the year preceding that day;
- (b) for all other purposes, on the ordinary day of election of councillors and community councillors following the making of this Order, which is the appointed day for the purposes of the Regulations for articles 6, 7 and 11.

Interpretation

3. In this Order—

“existing” (“*presennol*”) in relation to a local government or electoral area, means that area as it exists immediately before the appointed day;

“new” (“*newydd*”), in relation to a local government or electoral area, means that area as established by this Order;

“the Regulations” (“*y Rheoliadau*”) means the Local Government Area Changes Regulations 1976(1);

any reference to a map means one of the seven maps marked “Map of the Torfaen (Communities) Order 2013”, duly labelled 1 to 8 for reference and deposited in accordance with regulation 5 of the Regulations;

any reference to an electoral division is a reference to an electoral division of Torfaen County Borough; and

(1) S.I. 1976/246 (as amended by various statutory instruments which are not relevant to this Order).

os dangosir ar fap fod ffin yn rhedeg ar hyd ffordd, rheilffordd, troetffordd, cwrs dŵr neu nodwedd ddaearyddol debyg, caiff ei thrin fel un sy'n rhedeg ar hyd llinell ganol y nodwedd.

Newidiadau yn ardaloedd llywodraeth leol

4. Mae newidiadau wedi eu gwneud yn ardal llywodraeth leol Bwrdeistref Sirol Torfaen yn unol â darpariaethau canlynol y Gorchymyn hwn.

Croesyceiliog a New Inn – Newidiadau i Ardaloedd Cymunedol a Newidiadau Canlyniadol i'r Trefniadau Etholiadol

5.—(1) Mae'r rhannau o gymuned New Inn a ddangosir â chroeslinellau ar Fapiau 1 a 2—

- (a) wedi eu trosglwyddo i gymuned Croesyceiliog;
- (b) yn rhan o ward Gogledd Croesyceiliog yng nghymuned Croesyceiliog; ac
- (c) yn rhan o adran etholiadol Gogledd Croesyceiliog.

(2) Yng nghymuned Croesyceiliog, 5 yw nifer y cynghorwyr cymuned sydd i'w hethol ar gyfer ward Gogledd Croesyceiliog.

Llanyrafon – Newidiadau i Wardiau Cymunedol a Newidiadau Canlyniadol i'r Trefniadau Etholiadol

6.—(1) Yng nghymuned Llanyrafon—

- (a) mae wardiau cymunedol presennol Gogledd Llanyrafon a De Llanyrafon wedi eu diddymu;
- (b) mae wardiau cymunedol newydd Dwyrain Llanyrafon a Gorllewin Llanyrafon wedi eu creu, a ddangosir ar Fap 3 fel yr ardaloedd wedi eu marcio “Ward Dwyrain Llanyrafon” a “Ward Gorllewin Llanyrafon” yn y drefn honno;
- (c) mae adrannau etholiadol presennol Gogledd Llanyrafon a De Llanyrafon wedi eu diddymu;
- (d) mae adran etholiadol newydd Gorllewin Llanyrafon wedi ei chreu, gan gynnwys ward gymunedol newydd Gorllewin Llanyrafon;
- (e) mae adran etholiadol newydd Dwyrain Llanyrafon a Phonthir wedi ei chreu, gan gynnwys ward gymunedol newydd Dwyrain Llanyrafon a chymuned bresennol Ponthir;
- (f) 1 yw nifer y cynghorwyr cymuned sydd i'w hethol ar gyfer ward Dwyrain Llanyrafon a 3 yw'r nifer ar gyfer ward Gorllewin Llanyrafon; ac

where a boundary is shown on a map as running along a road, railway line, footway, watercourse or similar geographical feature, it is treated as running along the centre line of the feature.

Local government area changes

4. Changes are made in the local government area of Torfaen County Borough in accordance with the following provisions of this Order.

Croesyceiliog and New Inn – Changes to Community Areas and Consequential Changes to Electoral Arrangements

5.—(1) The parts of the community of New Inn shown hatched on Maps 1 and 2—

- (a) are transferred to the community of Croesyceiliog;
- (b) form part of the Croesyceiliog North ward of the community of Croesyceiliog; and
- (c) form part of the electoral division of Croesyceiliog North.

(2) In the community of Croesyceiliog the number of community councillors to be elected for the ward of Croesyceiliog North is 5.

Llanyrafon – Changes to Community Wards and Consequential Changes to Electoral Arrangements

6.—(1) In the community of Llanyrafon—

- (a) the existing community wards of Llanyrafon North and Llanyrafon South are abolished;
- (b) the new community wards of Llanyrafon East and Llanyrafon West are created, shown on Map 3 as the areas marked “Llanyrafon East Ward” and “Llanyrafon West Ward” respectively;
- (c) the existing electoral divisions of Llanyrafon North and Llanyrafon South are abolished;
- (d) the new electoral division of Llanyrafon West is created, comprising the new community ward of Llanyrafon West;
- (e) the new electoral division of Llanyrafon East and Ponthir is created, comprising the new community ward of Llanyrafon East and the existing community of Ponthir;
- (f) the number of community councillors to be elected for the Llanyrafon East ward is 1 and for the Llanyrafon West ward is 3; and

- (g) 1 yw nifer y cyngorwyr sydd i'w hethol ar gyfer adran etholiadol Dwyrain Llanyrafon a Phonthir ac 1 yw'r nifer ar gyfer adran etholiadol Gorllewin Llanyrafon.

- (g) the number of councillors to be elected for the Llanyrafon East and Ponthir electoral division is 1 and for the Llanyrafon West electoral division is 1.

Abersychan a Phen Tranch – Newidiadau i Ardaloedd Cymunedol a Newidiadau Canlyniadol i'r Trefniadau Etholiadol

7. Mae'r rhan o gymuned Abersychan a ddangosir â chroeslinellau ar Fap 4—

- (a) wedi ei throsglwyddo i gymuned Pen Tranch;
- (b) yn rhan o ward Snatchwood yng nghymuned Pen Tranch; ac
- (c) yn rhan o adran etholiadol Snatchwood.

Abersychan and Pen Tranch – Changes to Community Areas and Consequential Changes to Electoral Arrangements

7. The part of the community of Abersychan shown hatched on Map 4—

- (a) is transferred to the community of Pen Tranch;
- (b) forms part of the Snatchwood ward of the community of Pen Tranch; and
- (c) forms part of the electoral division of Snatchwood.

Cwmbrân Uchaf a Phontnewydd – Newidiadau i Ardaloedd Cymunedol a Newidiadau Canlyniadol i'r Trefniadau Etholiadol

8. Mae'r rhan o gymuned Cwmbrân Uchaf a ddangosir â chroeslinellau ar Fap 5—

- (a) wedi ei throsglwyddo i gymuned Pontnewydd;
- (b) yn rhan o ward Mount Pleasant yng nghymuned Pontnewydd; ac
- (c) yn rhan o adran etholiadol Pontnewydd.

Upper Cwmbran and Pontnewydd – Changes to Community Areas and Consequential Changes to Electoral Arrangements

8. The part of the community of Upper Cwmbran shown hatched on Map 5—

- (a) is transferred to the community of Pontnewydd;
- (b) forms part of the Mount Pleasant ward of the community of Pontnewydd; and
- (c) forms part of the electoral division of Pontnewydd.

Fairwater a Chwmbrân Canolog – Newidiadau i Ardaloedd Cymunedol a Newidiadau Canlyniadol i'r Trefniadau Etholiadol

9. Mae'r rhan o gymuned Fairwater a ddangosir â chroeslinellau ar Fap 6—

- (a) wedi ei throsglwyddo i gymuned Cwmbrân Canolog;
- (b) yn rhan o ward St Dials yng nghymuned Cwmbrân Canolog; ac
- (c) yn rhan o adran etholiadol St Dials.

Fairwater and Cwmbran Central – Changes to Community Areas and Consequential Changes to Electoral Arrangements

9. The part of the community of Fairwater shown hatched on Map 6—

- (a) is transferred to the community of Cwmbran Central;
- (b) forms part of the St Dials ward of the community of Cwmbran Central; and
- (c) forms part of the electoral division of St Dials.

Fairwater a Chwmbrân Uchaf – Newidiadau i Ardaloedd Cymunedol a Newidiadau Canlyniadol i'r Trefniadau Etholiadol

10.—(1) Mae'r rhan o gymuned Fairwater a ddangosir â chroeslinellau ar Fap 7—

- (a) wedi ei throsglwyddo i gymuned Cwmbrân Uchaf; a

Fairwater and Upper Cwmbran – Changes to Community Areas and Consequential Changes to Electoral Arrangements

10.—(1) The part of the community of Fairwater shown hatched on Map 7—

- (a) is transferred to the community of Upper Cwmbran; and

(b) yn rhan o adran etholiadol Cwmbrân Uchaf.

(b) forms part of the electoral division of Upper Cwmbran.

(2) Yng nghymuned Cwmbrân Uchaf, mae ward gymunedol newydd Thornhill wedi ei chreu, gan gynnwys yr ardal a ddangosir â chroeslinellau ar Fap 8.

(2) In the community of Upper Cwmbran the new community ward of Thornhill is created, comprising the area shown hatched on Map 8.

(3) Yng nghymuned Cwmbrân Uchaf, 1 yw nifer y cynghorwyr cymuned sydd i'w hethol ar gyfer pob un o wardiau Dwyrain Cwmbrân Uchaf, Gorllewin Cwmbrân Uchaf a Thornhill.

(3) In the community of Upper Cwmbran the number of community councillors to be elected for each of the wards of Upper Cwmbran East, Upper Cwmbran West and Thornhill is 1.

Lesley Griffiths

Y Gweinidog Llywodraeth Leol a Busnes y
Llywodraeth, un o Weinidogion Cymru
28 Awst 2013

Minister for Local Government and Government
Business, one of the Welsh Ministers
28 August 2013

Map 1 Gorchymyn Torfaen (Cymunedau) 2013

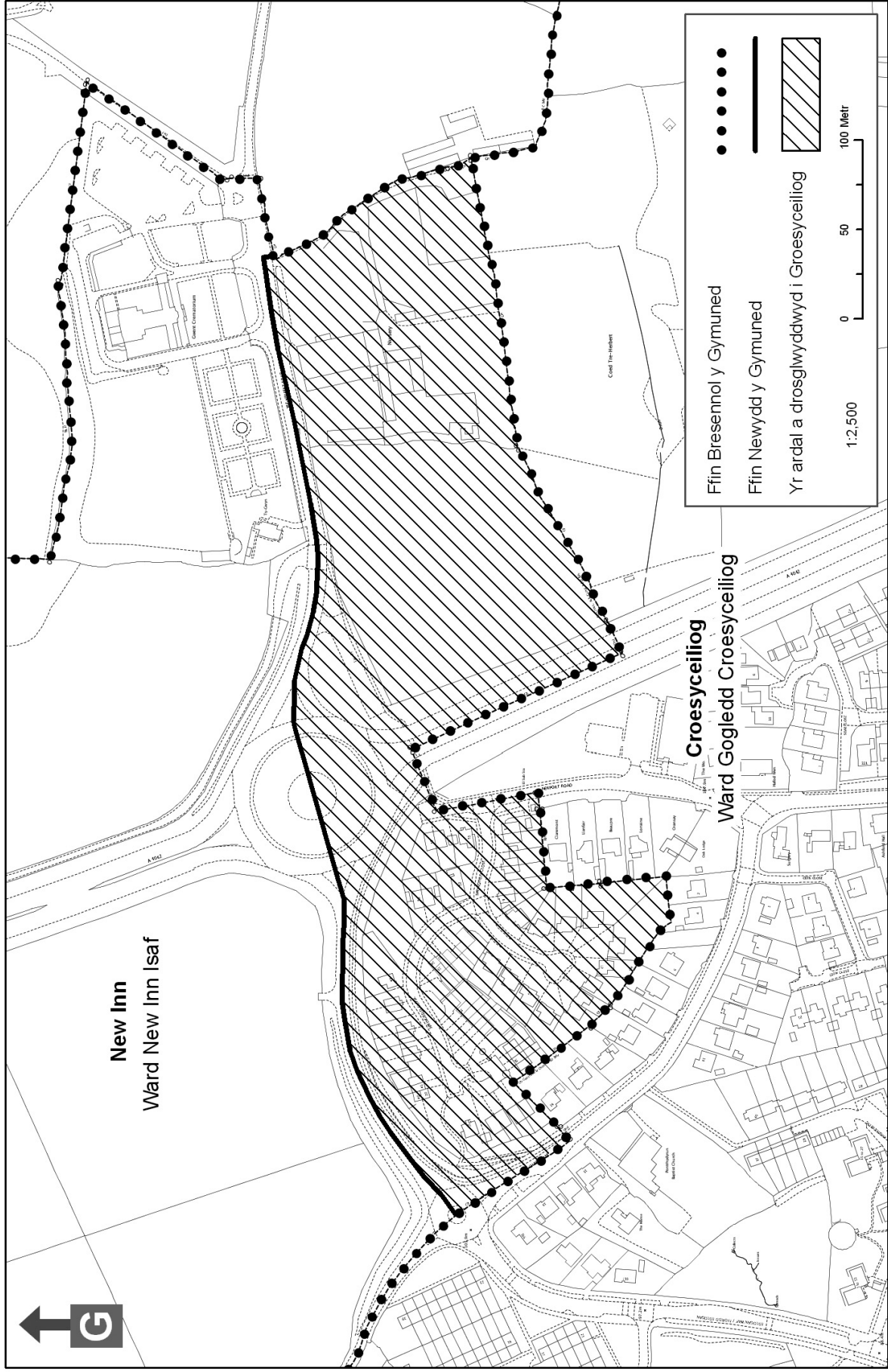

Mae'r map hwn yn seiliedig ar ddeunydd yr Arolwg Ordhans gyda chaniatâd yr Arolwg Ordhans ar ran Rheolwr Gwasg Ei Mawrhydi, © Hawlfraint y Goron 2013.
 Mae atgynhyrchu heb awdurdod yn torri hawlfraint y Goron a gall arwain at erlyn neu achos sifil. Llywodraeth Cymru. Rhif y Dwydded: 100021874

199/12-13 Cynhyrwyd gan Gartograffeg.
 Daearyddiaeth a Thechnoleg. Llywodraeth Cymru

Map 2 Gorchymyn Torfaen (Cymunedau) 2013

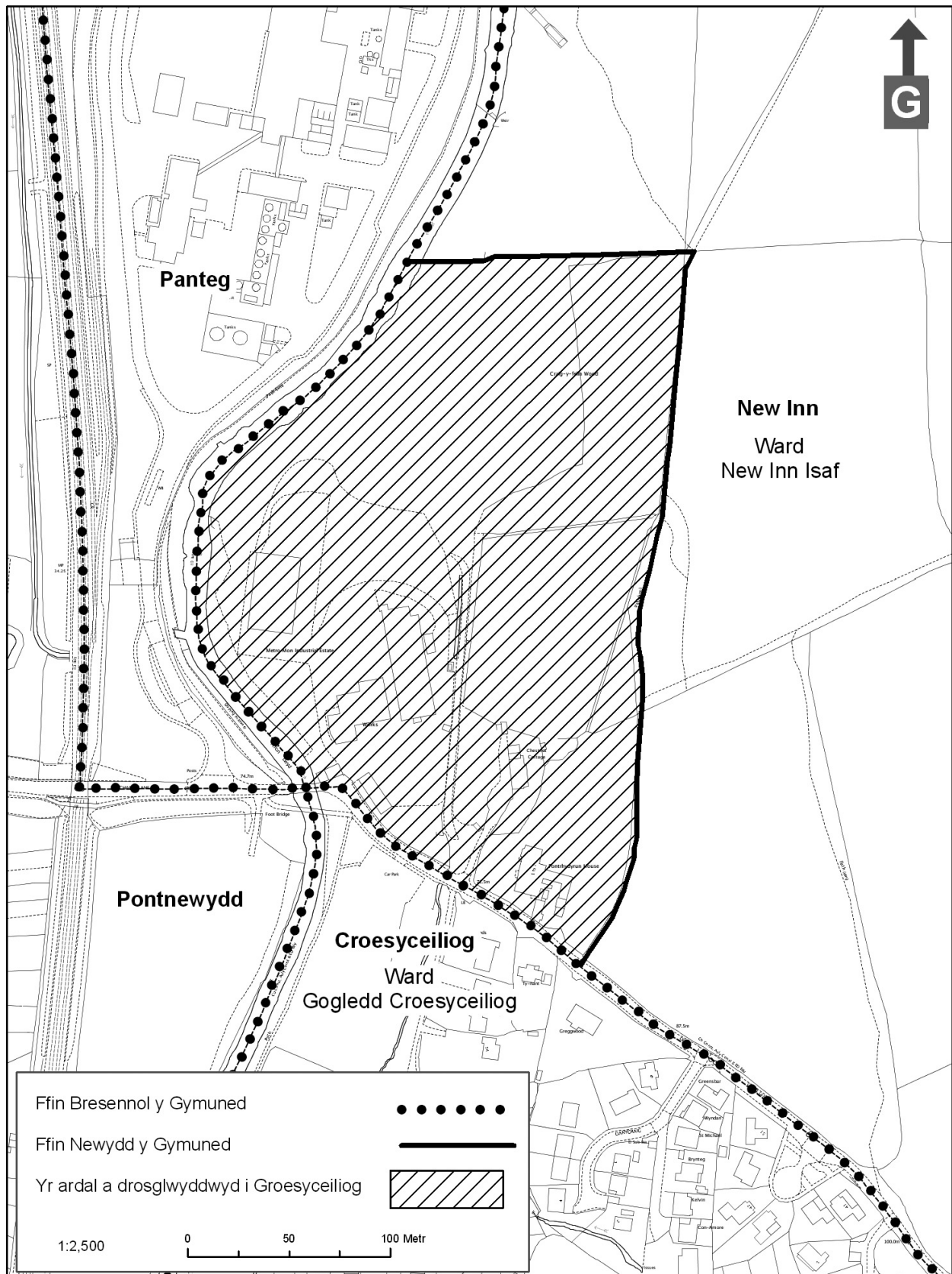

Mae'r map hwn yn seiliedig ar ddeunydd yr Arolwg Ordnans gyda chaniatâd yr Arolwg Ordnans ar ran Rheolwr Gwasg Ei Mawrhydi, © Hawlfraint y Goron 2013.
Mae atgynhyrchu heb awdurdod yn torri hawlfraint y Goron a gall arwain at erlyn neu achos sifil.
Llywodraeth Cymru. Rhify Drwydded: 100021874

199.12-13 Cynhyrwyd gan Gartograffeg,
Daearyddiaeth a Thechnoleg, Llywodraeth Cymru

Map 4 Gorchymyn Torfaen (Cymunedau) 2013

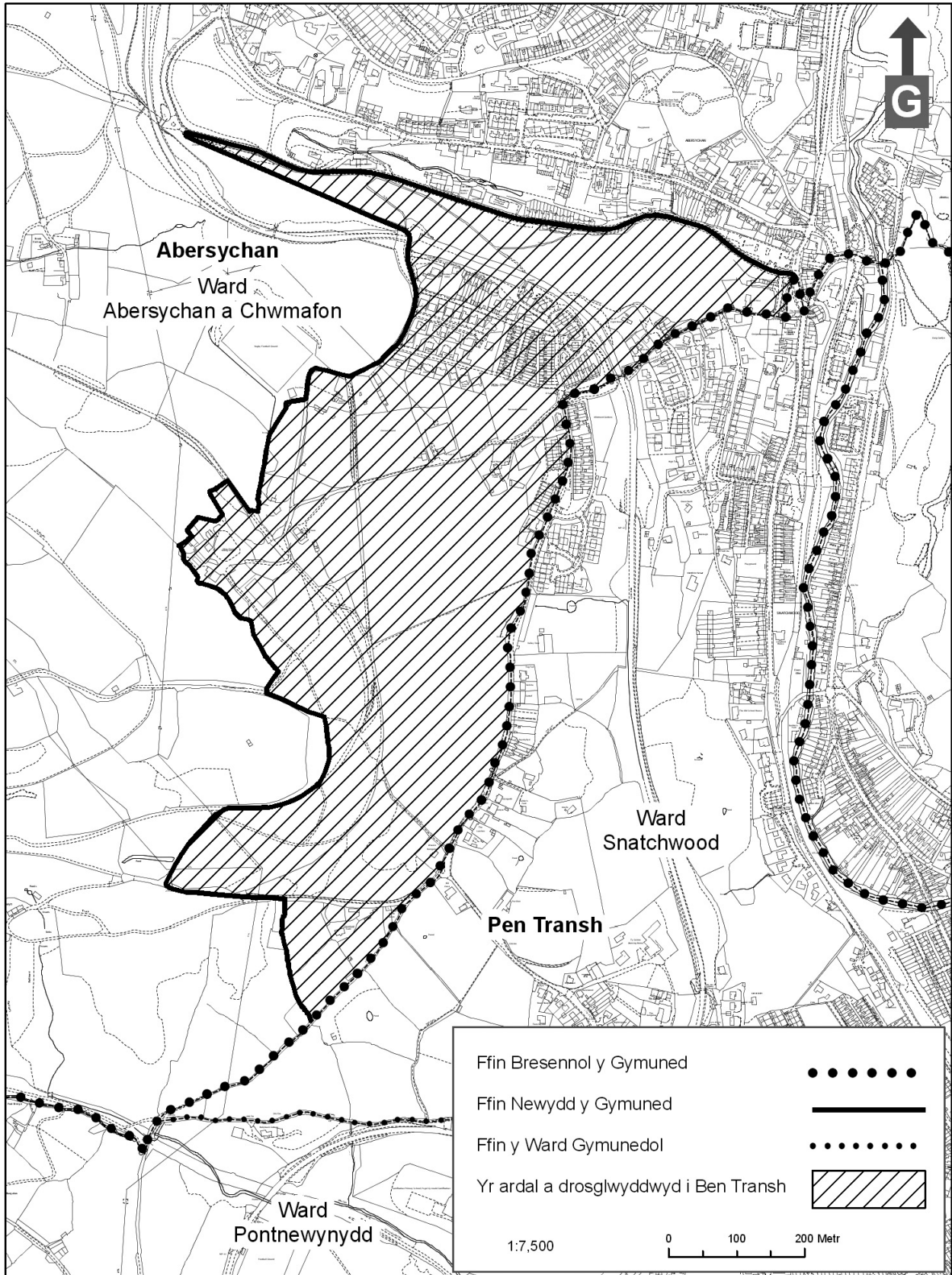

Mae'r map hwn yn seiliedig ar ddeunydd yr Arolwg Ordnans gyda chaniatâd yr Arolwg Ordnans ar ran Rheolwr Gwasg Ei Mawrhydi, © Hawlfraint y Goron 2013.
Mae atgynhyrchu heb awdurdod yn torri hawlfraint y Goron a gall arwain at erlyn neu achos sifil.
Llywodraeth Cymru. Rhify Drwydded: 100021874

199.12-13 Cynhyrchwyd gan Gartograffeg,
Daearyddiaeth a Thechnoleg, Llywodraeth Cymru

Map 5 Gorchymyn Torfaen (Cymunedau) 2013

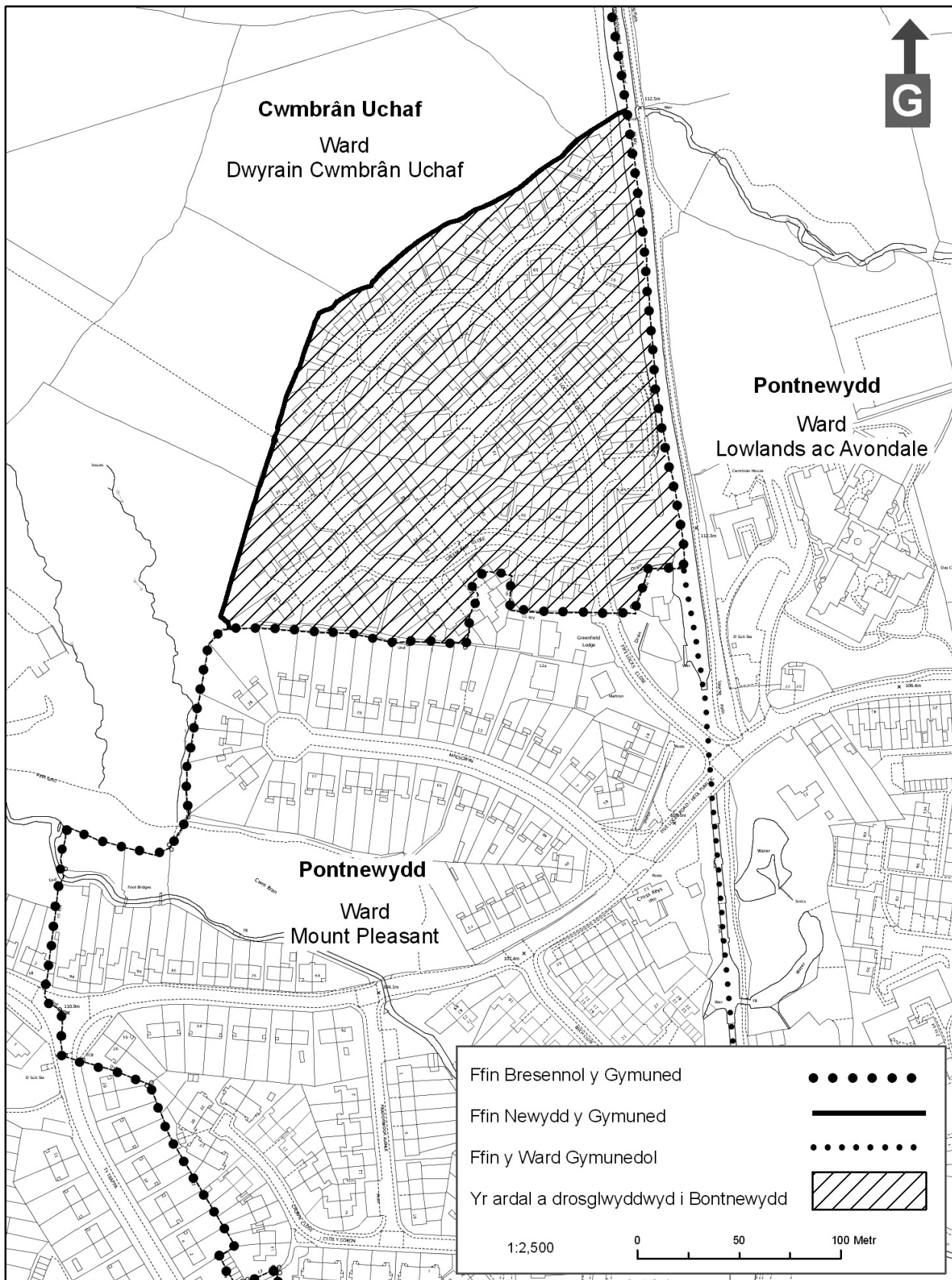

Mae'r map hwn yn seiliedig ar ddeunydd yr Arolwg Ordnans gyda chaniatâd yr Arolwg Ordnans ar ran Rheolwr Gwasg Ei Mawrhydi, © Hawlfraint y Goron 2013.
 Mae atgynhyrchu heb awdurdod yn torri hawlfraint y Goron a gall arwain at erlyn neu achos sifil.
 Llywodraeth Cymru. Rhify Drwydded: 100021874

199.12-13 Cynhyrwyd gan Gartograffeg, Daearyddiaeth a Thechnoleg, Llywodraeth Cymru

Map 7 Gorchymyn Torfaen (Cymunedau) 2013

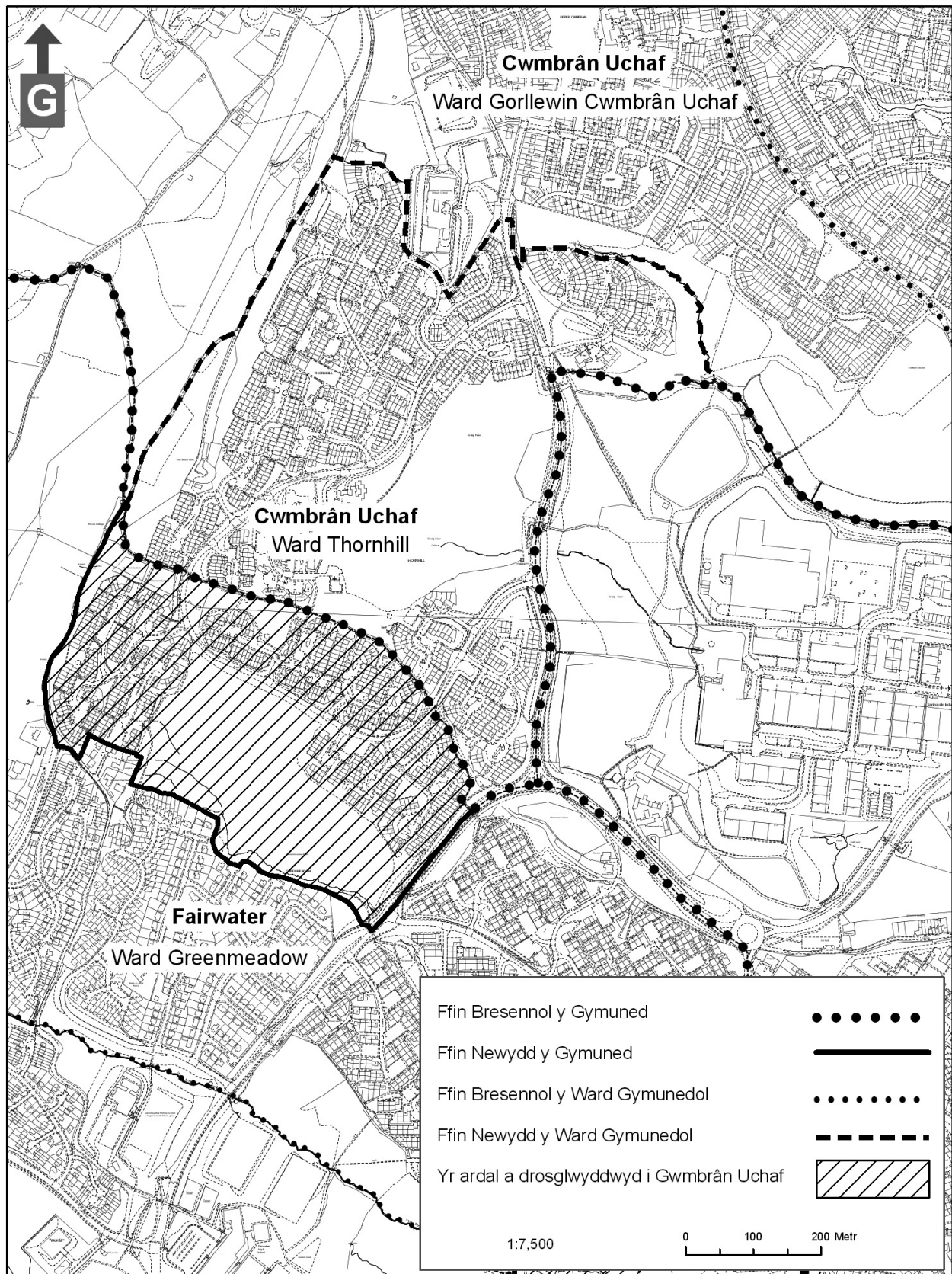

Mae'r map hwn yn seiliedig ar ddeunydd yr Arolwg Ordnans gyda chaniatâd yr Arolwg Ordnans ar ran Rheolwr Gwasg Ei Mawrhydi, © Hawlfraint y Goron 2013.

Mae atgynhyrchu heb awdurdod yn torri hawlfraint y Goron a gall arwain at erlyn neu achos sifil. Llywodraeth Cymru. Rhifyn Drwydded: 100021874

199.12-13 Cynhyrwyd gan Gartograffeg, Daearyddiaeth a Thechnoleg, Llywodraeth Cymru

Map 8 Gorchymyn Torfaen (Cymunedau) 2013

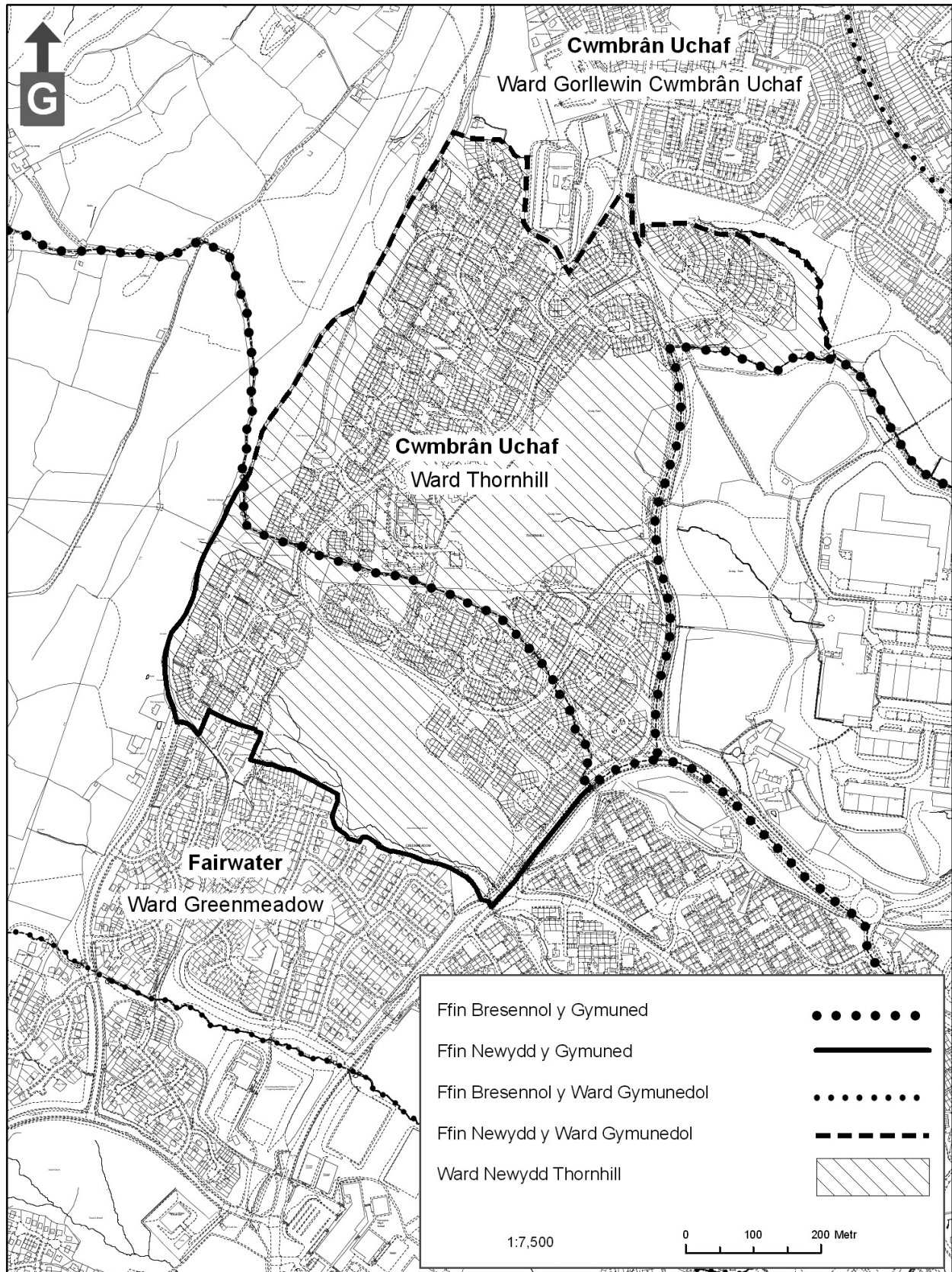

Mae'r map hwn yn seiliedig ar ddeunydd yr Arolwg Ordnans gyda chaniatâd yr Arolwg Ordnans ar ran Rheolwr Gwasg Ei Mawrhydi, © Hawlfraint y Goron 2013.

Mae atgynhyrchu heb awdurdod yn torri hawlfraint y Goron a gall arwain at erlyn neu achos sifil. Llywodraeth Cymru. Rhif y Drwydded: 100021874

199.12-13 Cynhyrchwyd gan Gartograffeg, Daearyddiaeth a Thechnoleg, Llywodraeth Cymru

Map 1 of the Torfaen (Communities) Order 2013

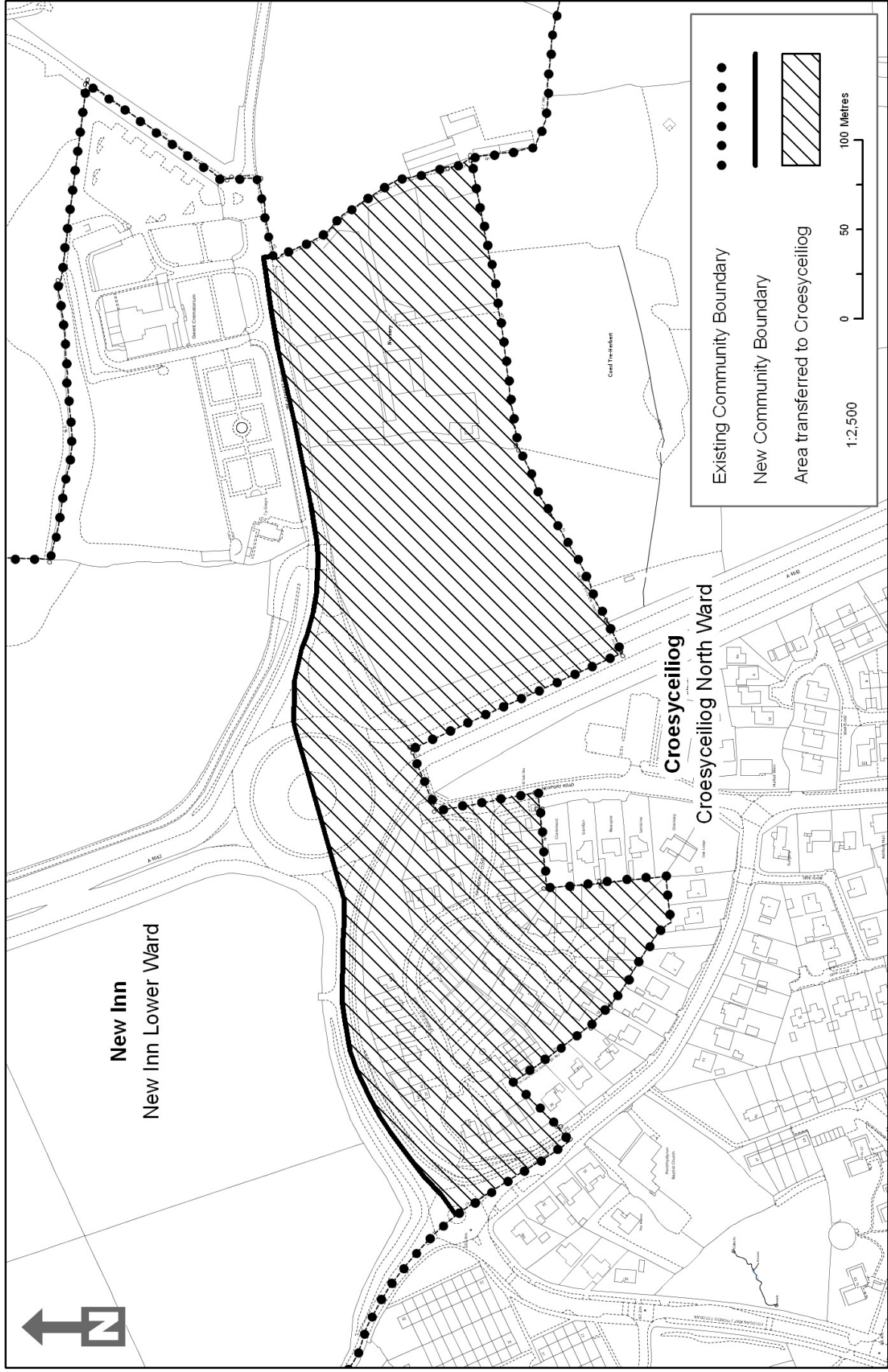

This map is based upon the Ordnance Survey material with the permission of the Ordnance Survey on behalf of The Controller of Her Majesty's Stationery Office, © Crown copyright, 2013. Unauthorised reproduction infringes Crown copyright and may lead to prosecution or civil proceedings. Welsh Government. Licence Number: 100021874

Map 2 of the Torfaen (Communities) Order 2013

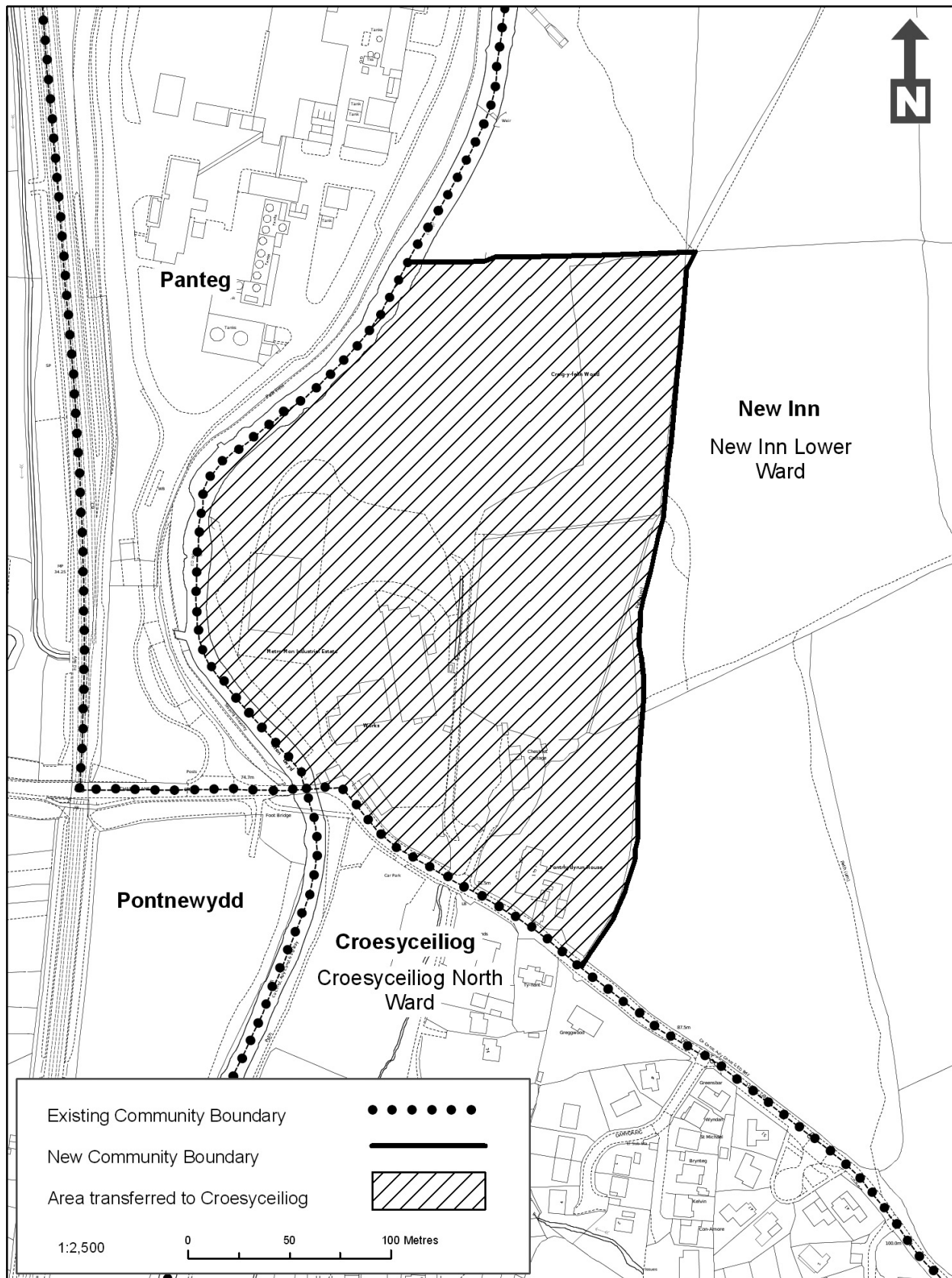

This map is based upon the Ordnance Survey material with the permission of the Ordnance Survey on behalf of The Controller of Her Majesty's Stationery Office, © Crown copyright 2013. Unauthorised reproduction infringes Crown copyright and may lead to prosecution or civil proceedings. Welsh Government. Licence Number: 100021874

199.12-13 Produced by Cartographics, Geography & Technology, Welsh Government

Map 3 of the Torfaen (Communities) Order 2013

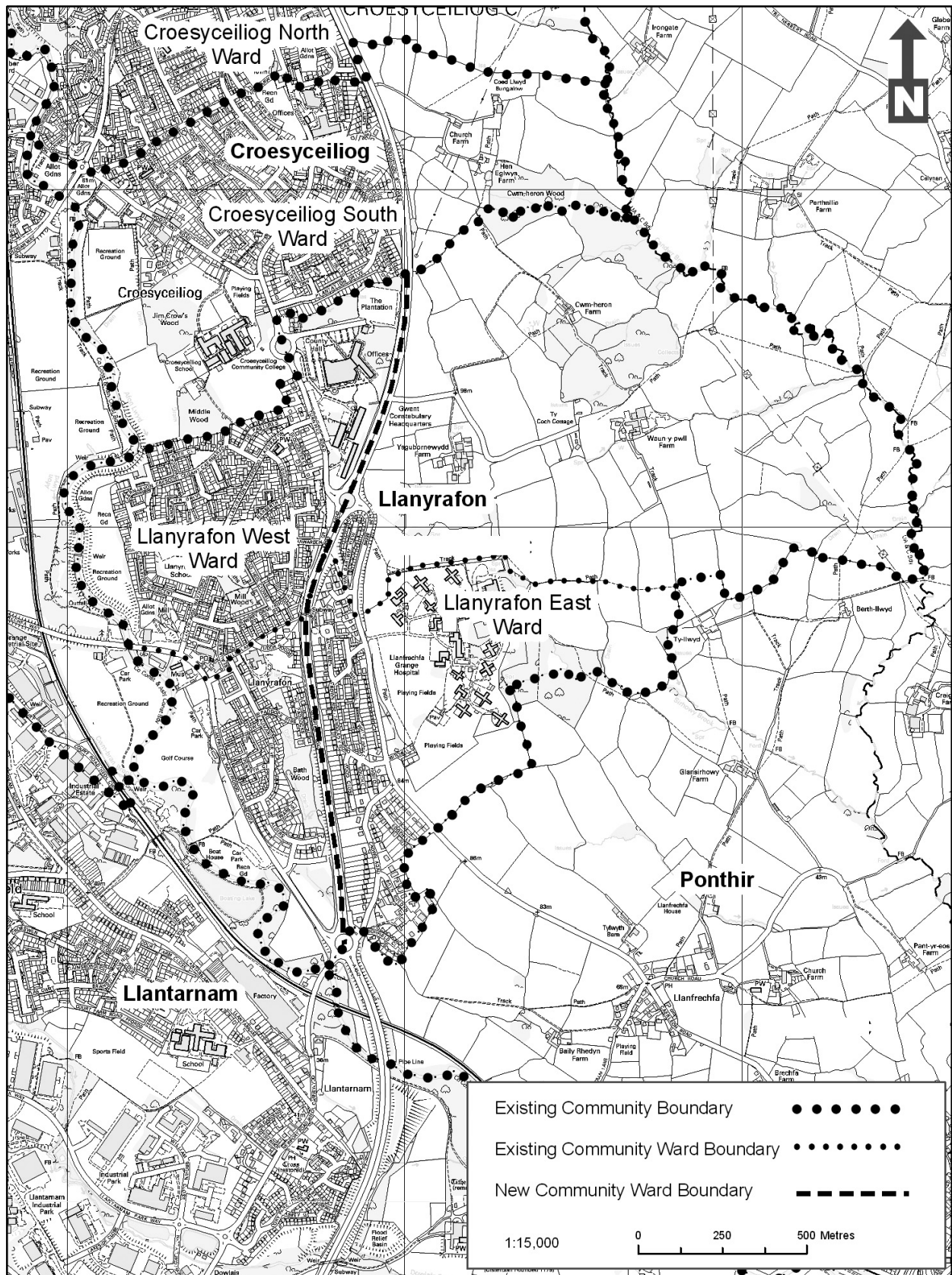

This map is based upon the Ordnance Survey material with the permission of the Ordnance Survey on behalf of The Controller of Her Majesty's Stationery Office, © Crown copyright 2013. Unauthorised reproduction infringes Crown copyright and may lead to prosecution or civil proceedings. Welsh Government. Licence Number: 100021874

199.12-13 Produced by Cartographics, Geography & Technology, Welsh Government

Map 4 of the Torfaen (Communities) Order 2013

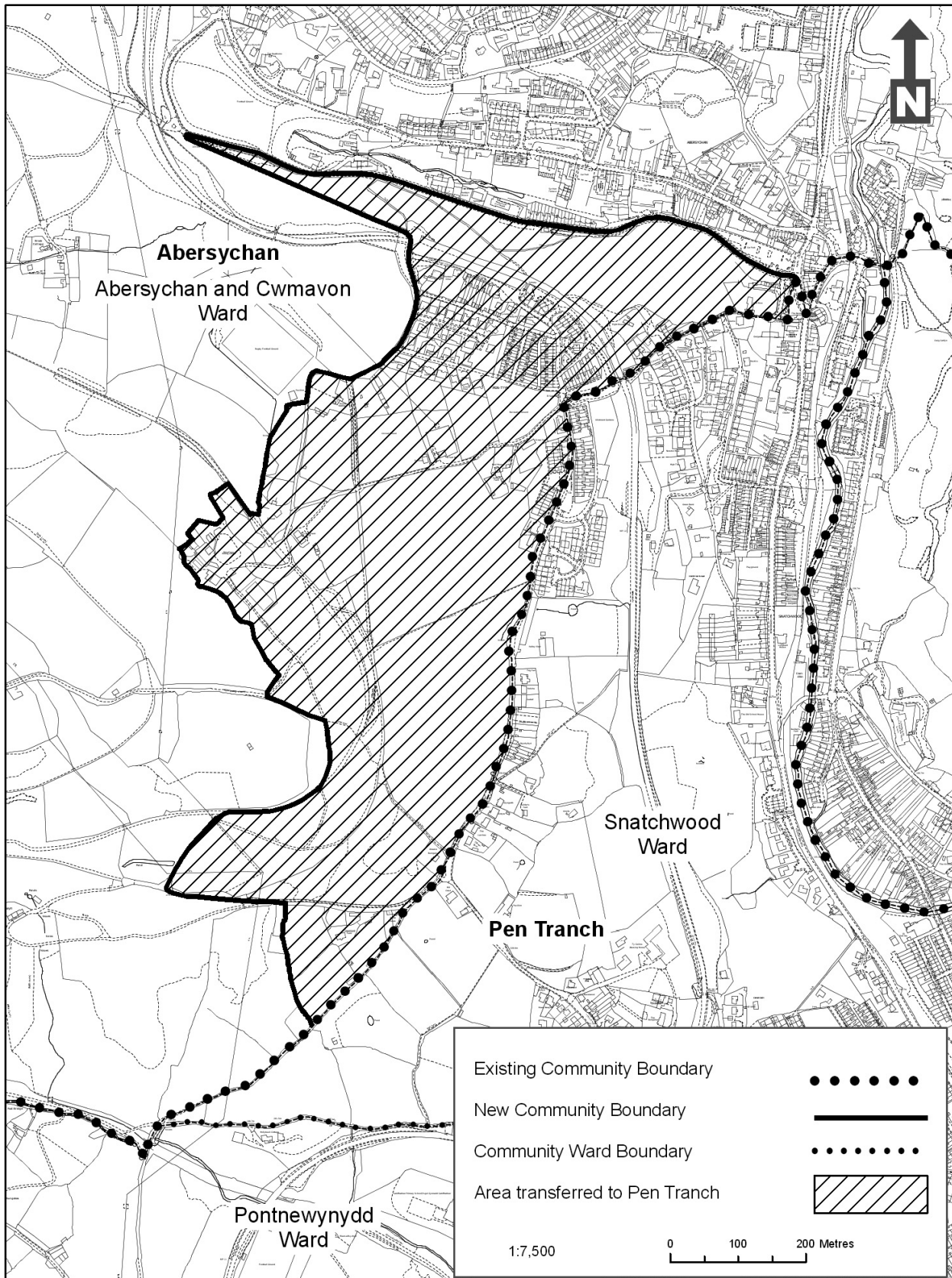

This map is based upon the Ordnance Survey material with the permission of the Ordnance Survey on behalf of The Controller of Her Majesty's Stationery Office, © Crown copyright 2013. Unauthorised reproduction infringes Crown copyright and may lead to prosecution or civil proceedings. Welsh Government. Licence Number: 100021874

199.12-13 Produced by Cartographics, Geography & Technology, Welsh Government

Map 5 of the Torfaen (Communities) Order 2013

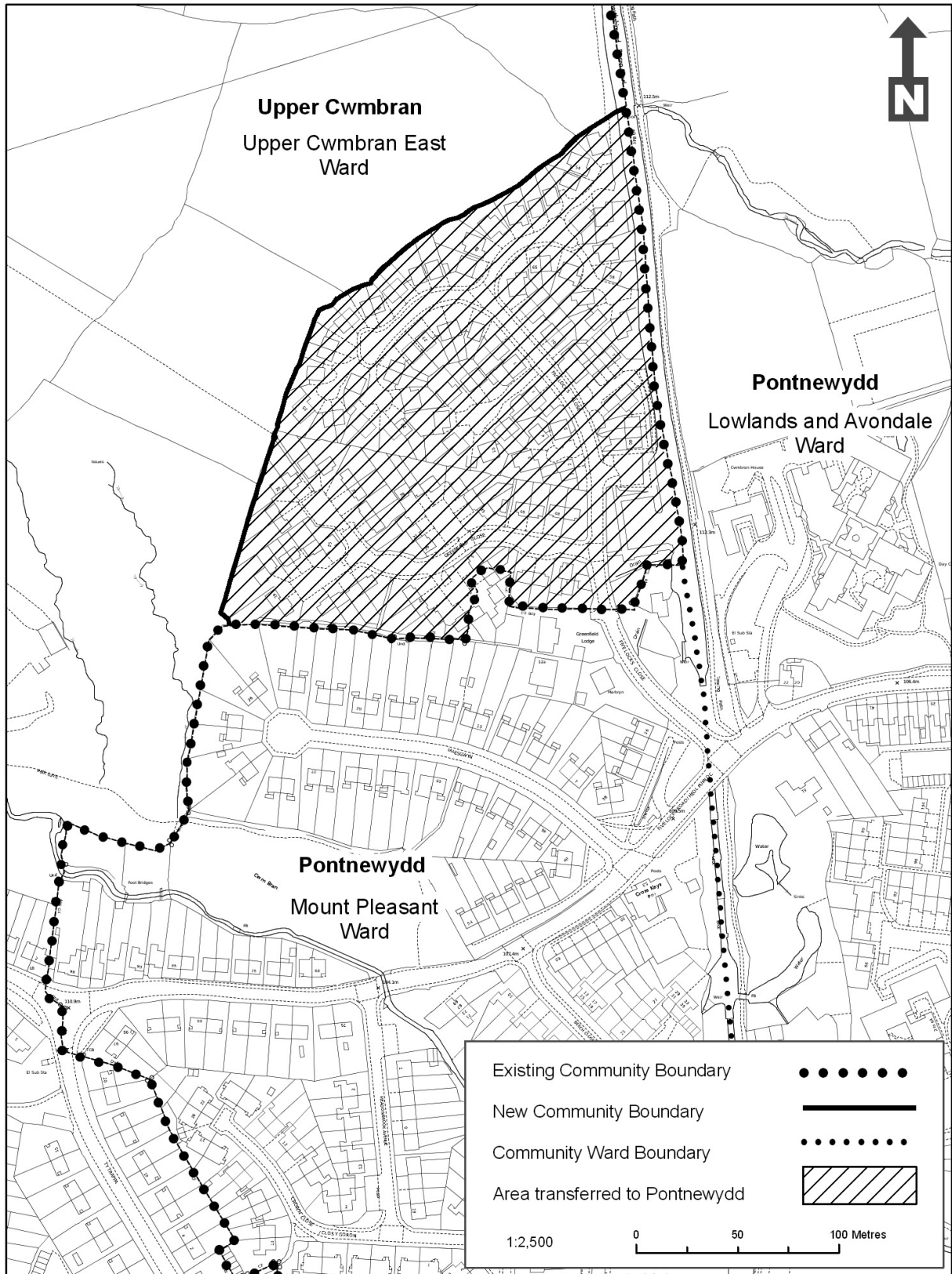

This map is based upon the Ordnance Survey material with the permission of the Ordnance Survey on behalf of The Controller of Her Majesty's Stationery Office, © Crown copyright 2013. Unauthorised reproduction infringes Crown copyright and may lead to prosecution or civil proceedings. Welsh Government. Licence Number: 100021874

199.12-13 Produced by Cartographics, Geography & Technology, Welsh Government

Map 6 of the Torfaen (Communities) Order 2013

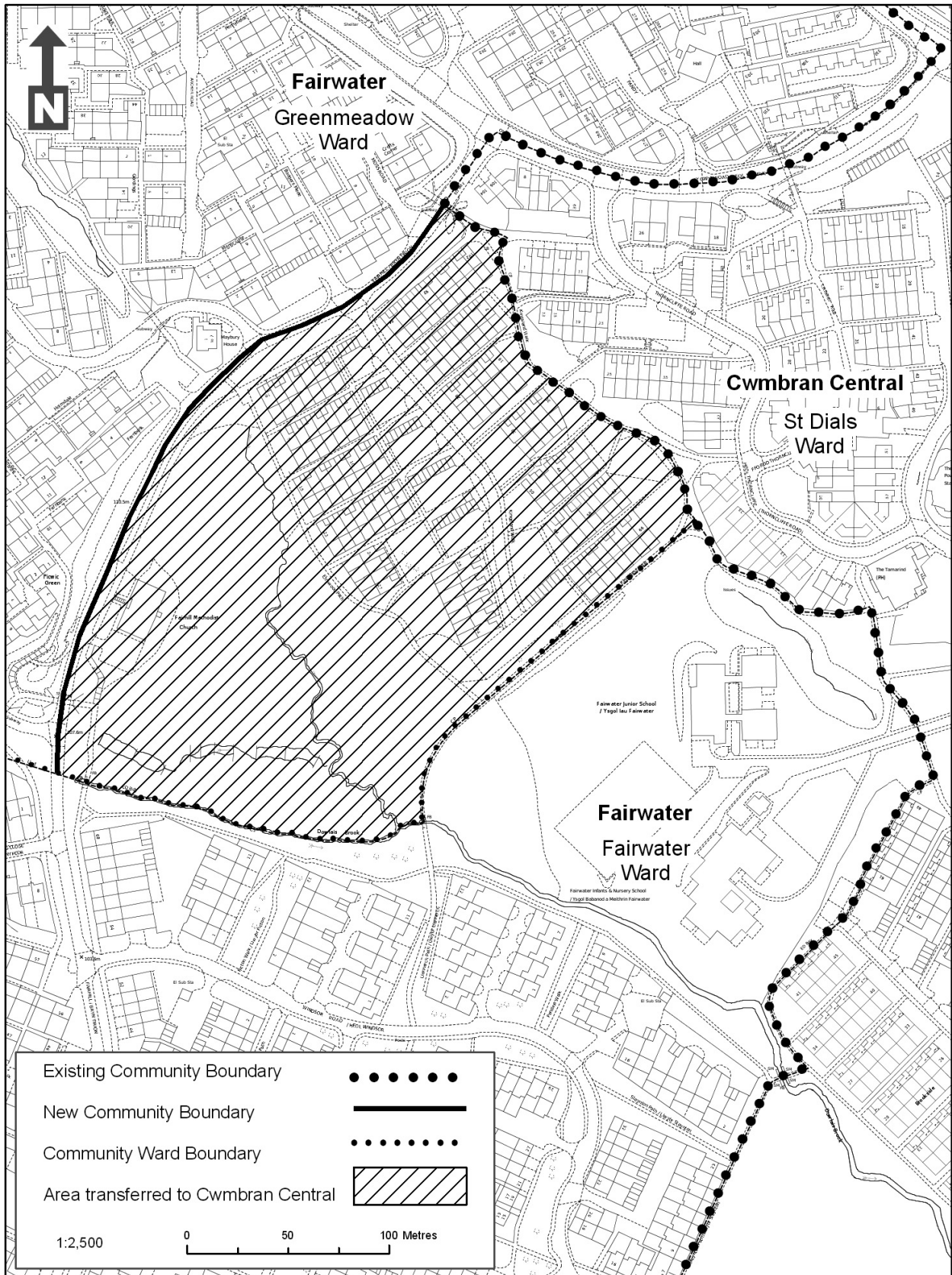

This map is based upon the Ordnance Survey material with the permission of the Ordnance Survey on behalf of The Controller of Her Majesty's Stationery Office, © Crown copyright 2013. Unauthorised reproduction infringes Crown copyright and may lead to prosecution or civil proceedings. Welsh Government. Licence Number: 100021874

199.12-13 Produced by Cartographics, Geography & Technology, Welsh Government

Map 7 of the Torfaen (Communities) Order 2013

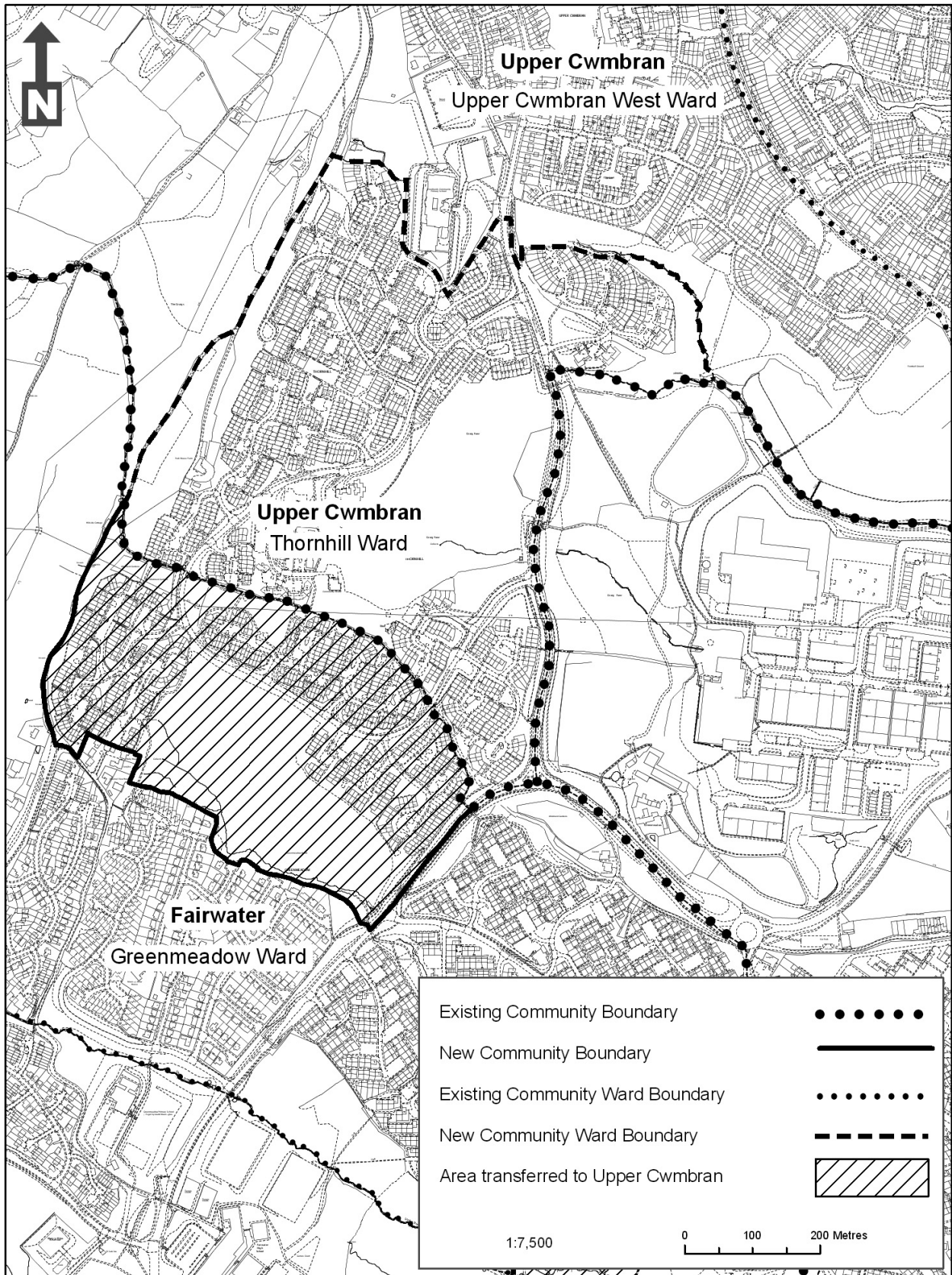

This map is based upon the Ordnance Survey material with the permission of the Ordnance Survey on behalf of The Controller of Her Majesty's Stationery Office, © Crown copyright 2013. Unauthorised reproduction infringes Crown copyright and may lead to prosecution or civil proceedings. Welsh Government. Licence Number: 100021874

199.12-13 Produced by Cartographics, Geography & Technology, Welsh Government

Map 8 of the Torfaen (Communities) Order 2013

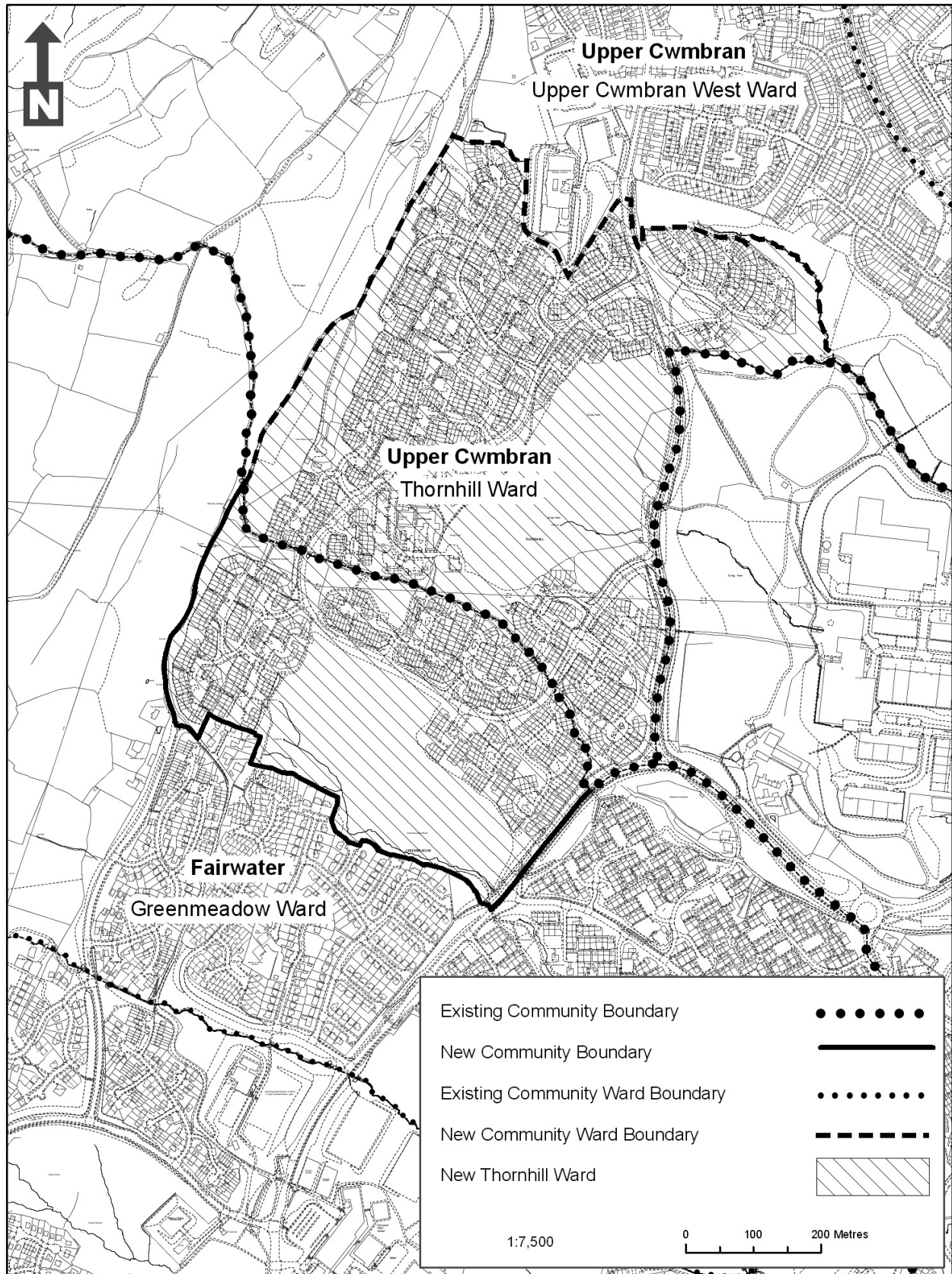

This map is based upon the Ordnance Survey material with the permission of the Ordnance Survey on behalf of The Controller of Her Majesty's Stationery Office, © Crown copyright 2013. Unauthorised reproduction infringes Crown copyright and may lead to prosecution or civil proceedings. Welsh Government. Licence Number: 100021874

199.12-13 Produced by Cartographics, Geography & Technology, Welsh Government

OFFERYNNAU STATUDOL
CYMRU

WELSH STATUTORY
INSTRUMENTS

2013 Rhif 2156 (Cy. 211)

2013 No. 2156 (W. 211)

**LLYWODRAETH LEOL,
CYMRU**

**LOCAL GOVERNMENT,
WALES**

Gorchymyn Torfaen (Cymunedau)
2013

The Torfaen (Communities) Order
2013

£5.75

W1704/09/13

ON

ISBN 978-0-348-10808-8



9 780348 108088