WELSH STATUTORY INSTRUMENTS

2009 No. 2718 (W.230)

LOCAL GOVERNMENT, WALES

The Wrexham (Communities) Order 2009

Made - - - - 4 October 2009

Coming into force in accordance with article 1(2) to (4)

The Local Government Boundary Commission for Wales have, in accordance with sections 54(1) and 58(1) of the Local Government Act 1972⁽¹⁾, submitted to the Welsh Ministers reports dated September 2007 and September 2008 on their reviews of, and proposals for, community boundaries within the County Borough of Wrexham.

The Welsh Ministers have decided to give effect to the proposals in the Commission's report of September 2007, except for the proposed change to the boundary between the communities of Abenbury and Caia Park, and to the proposals in the Commission's report dated September 2008 without modification.

More than six weeks have elapsed since those proposals were submitted to the Welsh Ministers.

The Welsh Ministers make the following Order in exercise of the powers conferred on the Secretary of State by section 58(2) of the Local Government Act 1972 and now vested in them so far as exercisable in relation to Wales⁽²⁾:

Title and commencement

1.—(1) The title of this Order is the Wrexham (Communities) Order 2009.

(2) Subject to paragraph (3), for any purpose set out in regulation 4(1) of the Regulations, this Order comes into force on 1 December 2009.

(3) Articles 5, 6, 8, 9 and 12 come into force—

(a) for the purpose of proceedings preliminary or relating to any election to be held on the ordinary day of election of councillors in 2012, on 15 October 2011;

(b) for all other purposes, on the ordinary day for election of councillors in 2012.

(4) For all other purposes, this Order comes into force on 1 April 2010, which is the appointed day for the purposes of the Regulations.

(1) 1972 c. 70.

(2) The powers of the Secretary of State were transferred to the National Assembly for Wales by the National Assembly for Wales (Transfer of Functions) Order 1999 (S.I.1999/672) and are now vested in the Welsh Ministers by virtue of paragraph 30 of Schedule 11 to the Government of Wales Act 2006 (2006 c. 32).

Interpretation

2. In this Order—

“the Regulations” (“*y Rheoliadau*”) means the Local Government Area Changes Regulations 1976(3);

any reference to a map means one of the seven maps marked “Maps of the Wrexham (Communities) Order 2009”, duly labelled “A” to “G” for reference and deposited in accordance with regulation 5 of the Regulations;

any reference to an electoral division is a reference to an electoral division of the County Borough of Wrexham; and

where a boundary is shown on a map as running along a road, railway line, footway, watercourse or similar geographical feature, it is to be treated as running along the centre line of the feature.

Caia Park and Abenbury — change in community areas and consequential changes to electoral arrangements

3. The part of the community of Caia Park shown hatched on Map A—

- (a) is transferred to the community of Abenbury; and
- (b) forms part of the electoral division of Holt.

4. The part of the community of Abenbury shown as hatched area “A” on Map B—

- (a) is transferred to the community of Caia Park;
- (b) forms part of the Cartrefle ward of the community of Caia Park; and
- (c) becomes part of the electoral division of Cartrefle.

5. The number of councillors to be elected for the community of Abenbury is 10.

6. In the community of Caia Park the number of councillors to be elected for the Cartrefle ward is 3, for the Queensway ward is 3, for the Smithfield ward is 3, for the Whitegate ward is 3 and for the Wynnstay ward is 2.

Holt, Caia Park and Acton — change in community areas and consequential changes to electoral arrangements

7. The part of the community of Holt shown as hatched area “B” on Map B and the part of the community of Caia Park shown on hatched area “C” on Map B—

- (a) are transferred to the community of Acton;
- (b) form part of the Rhosnesni ward of the community of Acton; and
- (c) become part of the electoral division of Rhosnesni.

8. In the community of Acton the number of councillors to be elected for the Acton Central ward is 2, for the Acton Park ward is 2, for the Borrass Park ward is 3, for the Little Acton ward is 3, for the Maesydre ward is 2 and for the Rhosnesni ward is 4.

9. The community of Holt is not warded and the number of councillors to be elected for the community of Holt is 10.

Minera and Coedpoeth — change in community areas and consequential changes to electoral arrangements

10. The part of the community of Minera shown hatched on Map C—
- (a) is transferred to the community of Coedpoeth;
 - (b) forms part of the South ward of the community of Coedpoeth; and
 - (c) becomes part of the electoral division of Coedpoeth.

Broughton and Brymbo — change in community areas and consequential changes to electoral arrangements

11. The part of the community of Broughton shown hatched on Map D—
- (a) is transferred to the community of Brymbo;
 - (b) forms part of the Brymbo ward of the community of Brymbo; and
 - (c) becomes part of the electoral division of Brymbo.

12. In the community of Broughton the number of councillors to be elected for each of the wards of Bryn Cefn, Brynteg, Gwenfro and New Broughton is 4.

Gresford and Gwersyllt — change in community areas and consequential changes to electoral arrangements

13. The parts of the community of Gresford shown hatched on Map E—
- (a) are transferred to the community of Gwersyllt;
 - (b) form part of the South ward of the community of Gwersyllt; and
 - (c) become part of the electoral division of Gwersyllt East and South.

14. The boundary between Gresford West ward and Gresford East ward in the community of Gresford is altered as shown on Map E marked as the “New Community Ward Boundary”.

Marchwiel and Sesswick — change in community areas

15. The part of the community of Marchwiel shown hatched on Map F is transferred to the community of Sesswick.

Holt and Isycoed — change in community areas

16. The part of the community of Holt shown hatched on Map G is transferred to the community of Isycoed.

4 October 2009

Brian Gibbons
Minister for Social Justice and Local
Government, one of the Welsh Ministers

Status: This is the original version (as it was originally made). This item of legislation is currently only available in its original format.

EXPLANATORY NOTE

(This note is not part of the Order)

This Order is made in accordance with section 58(2) of the Local Government Act 1972. It gives effect to proposals of the Local Government Boundary Commission for Wales (“the Commission”) which reported in September 2007 and September 2008 on its reviews of community boundaries in part of the County Borough of Wrexham. The Commission’s report dated September 2007 recommended changes to the boundaries of Abenbury, Acton, Broughton, Brymbo, Caia Park, Coedpoeth, Gresford, Gwersyllt, Holt, Isycoed, Marchwiel, Minera and Sesswick communities and consequential changes to electoral arrangements. The Commission’s report dated September 2008 recommended a change to the boundaries of Abenbury and Caia Park communities and a consequential change to electoral arrangements. This Order gives effect to the Commission’s recommendations in its 2007 report, except for the recommendation for the change to the boundary between the Communities of Abenbury and Caia Park, and it gives effect to the recommendations in the 2008 report without modification.

Prints of the maps showing the boundaries are deposited and may be inspected during normal office hours at the offices of Wrexham County Borough Council, The Guildhall, Wrexham LL11 1AY and at the offices of the Welsh Assembly Government at Cathays Park, Cardiff (Local Government Policy Division).

The Local Government Area Changes Regulations 1976 referred to in article 2 of this Order contain incidental, consequential, transitional and supplementary provisions about the effect and implementation of orders such as this.

Status: This is the original version (as it was originally made). This item of legislation is currently only available in its original format.

Map A of The Wrexham (Communities) Order 2009

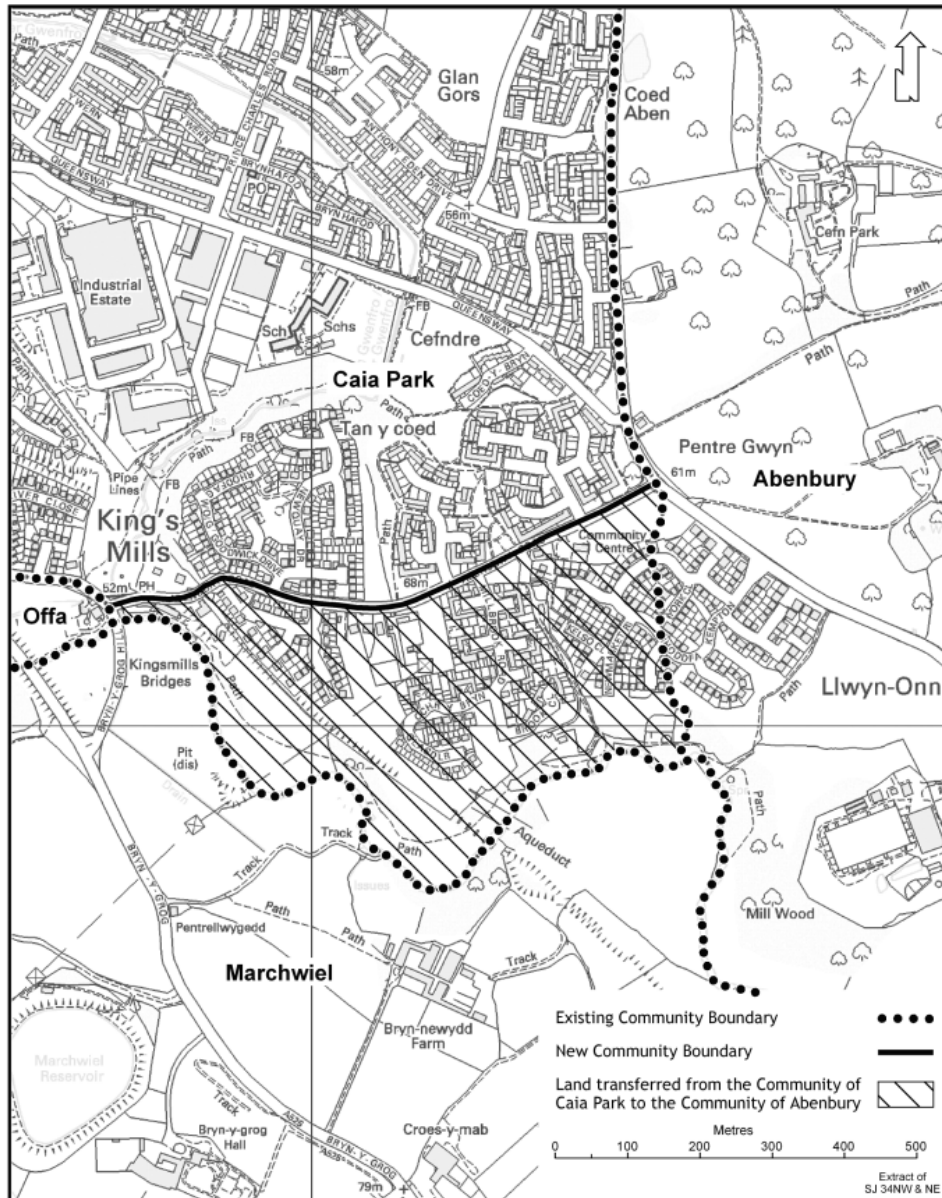

This map is based upon the Ordnance Survey map by the Welsh Assembly Government with the permission of The Controller of Her Majesty's Stationery Office. © Crown copyright 2009. All rights reserved. Unauthorised reproduction infringes Crown copyright and may lead to prosecution or civil proceedings. Licence Number: 100017916

296.08-09 Cartographics
Welsh Assembly Government

Status: This is the original version (as it was originally made). This item of legislation is currently only available in its original format.

Map B of The Wrexham (Communities) Order 2009

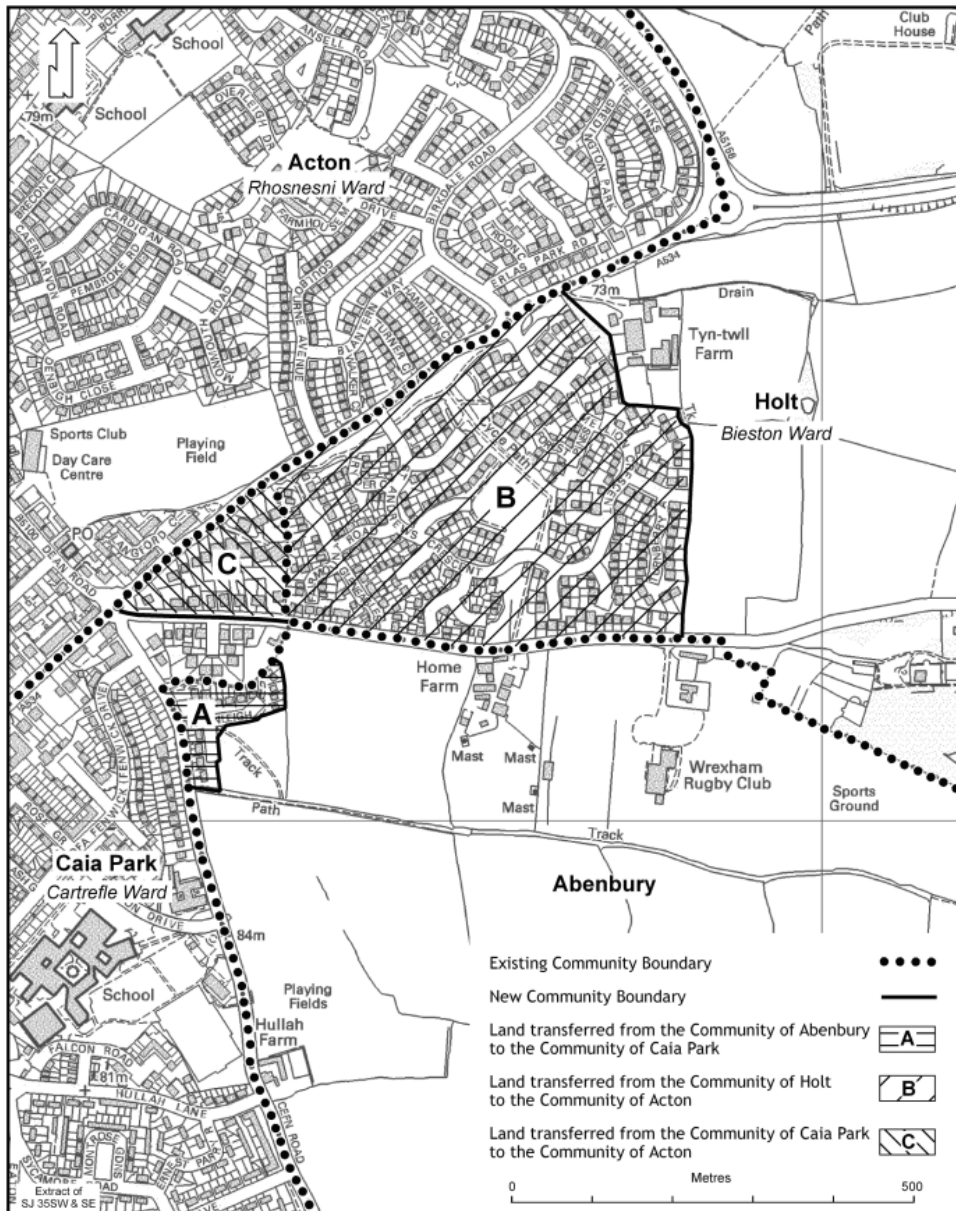

This map is based upon the Ordnance Survey map by the Welsh Assembly Government with the permission of The Controller of Her Majesty's Stationery Office. © Crown copyright 2009. All rights reserved. Unauthorised reproduction infringes Crown copyright and may lead to prosecution or civil proceedings. Licence Number: 100017916

Status: This is the original version (as it was originally made). This item of legislation is currently only available in its original format.

Map C of the Wrexham (Communities) Order 2009

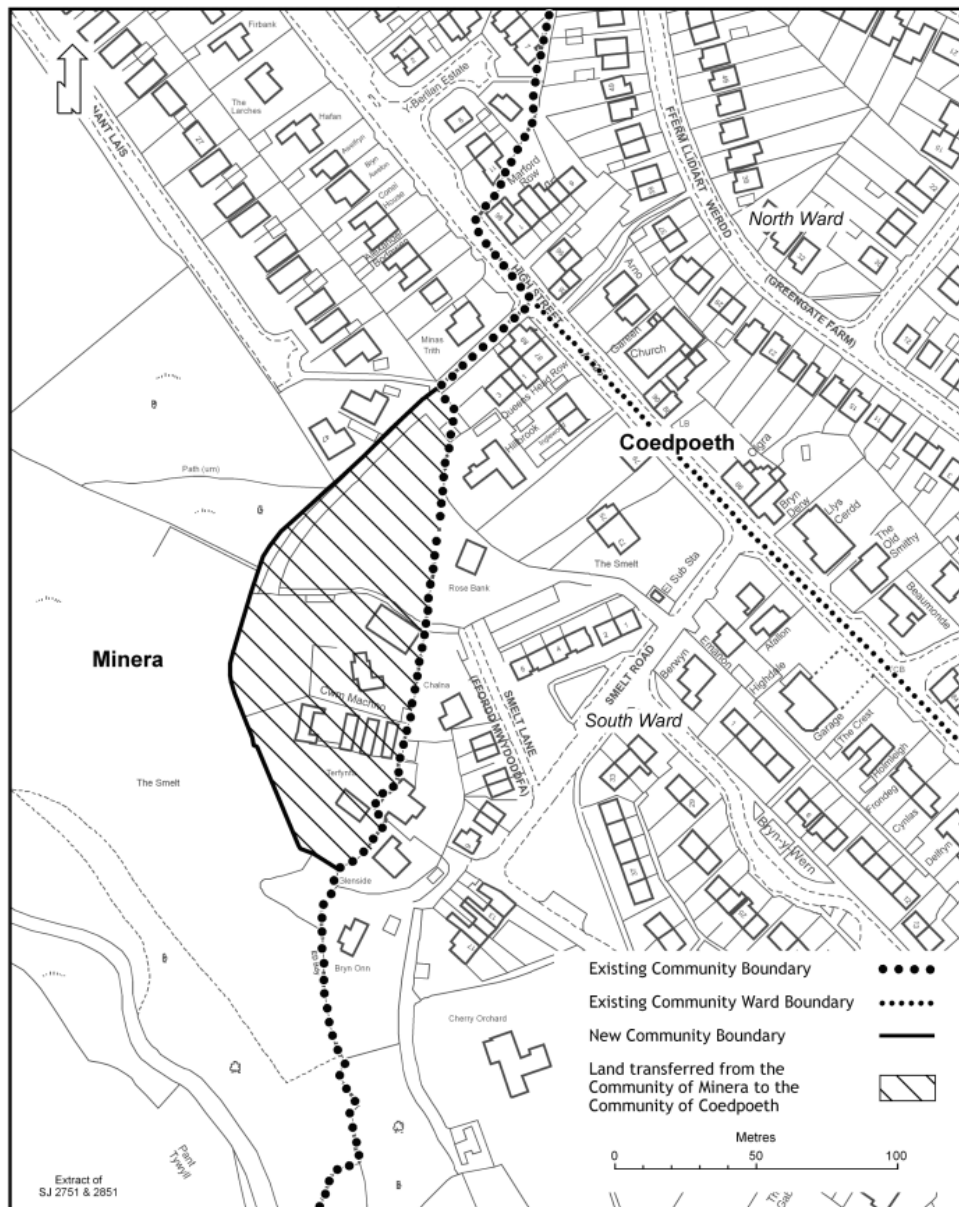

This map is based upon the Ordnance Survey map by the Welsh Assembly Government with the permission of The Controller of Her Majesty's Stationery Office. © Crown copyright 2009. All rights reserved. Unauthorised reproduction infringes Crown copyright and may lead to prosecution or civil proceedings. Licence Number: 100017916

296.08-09c Cartographics,
Welsh Assembly Government

Status: This is the original version (as it was originally made). This item of legislation is currently only available in its original format.

Map D of The Wrexham (Communities) Order 2009

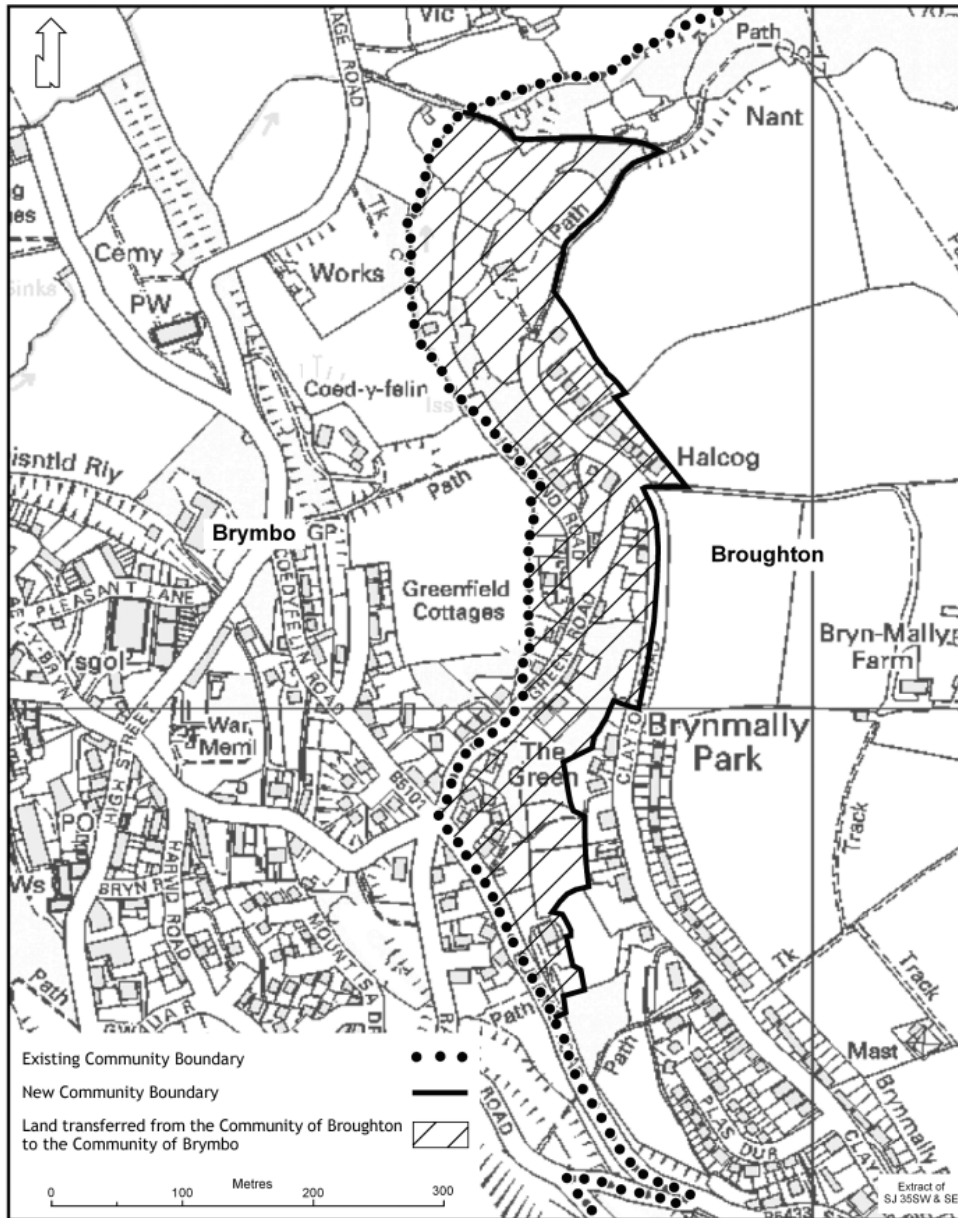

This map is based upon the Ordnance Survey map by the Welsh Assembly Government with the permission of The Controller of Her Majesty's Stationery Office. © Crown copyright 2009. All rights reserved. Unauthorised reproduction infringes Crown copyright and may lead to prosecution or civil proceedings. Licence Number: 100017916

296.08-09 Cartographics
Welsh Assembly Government

Status: This is the original version (as it was originally made). This item of legislation is currently only available in its original format.

Map E of the Wrexham (Communities) Order 2009

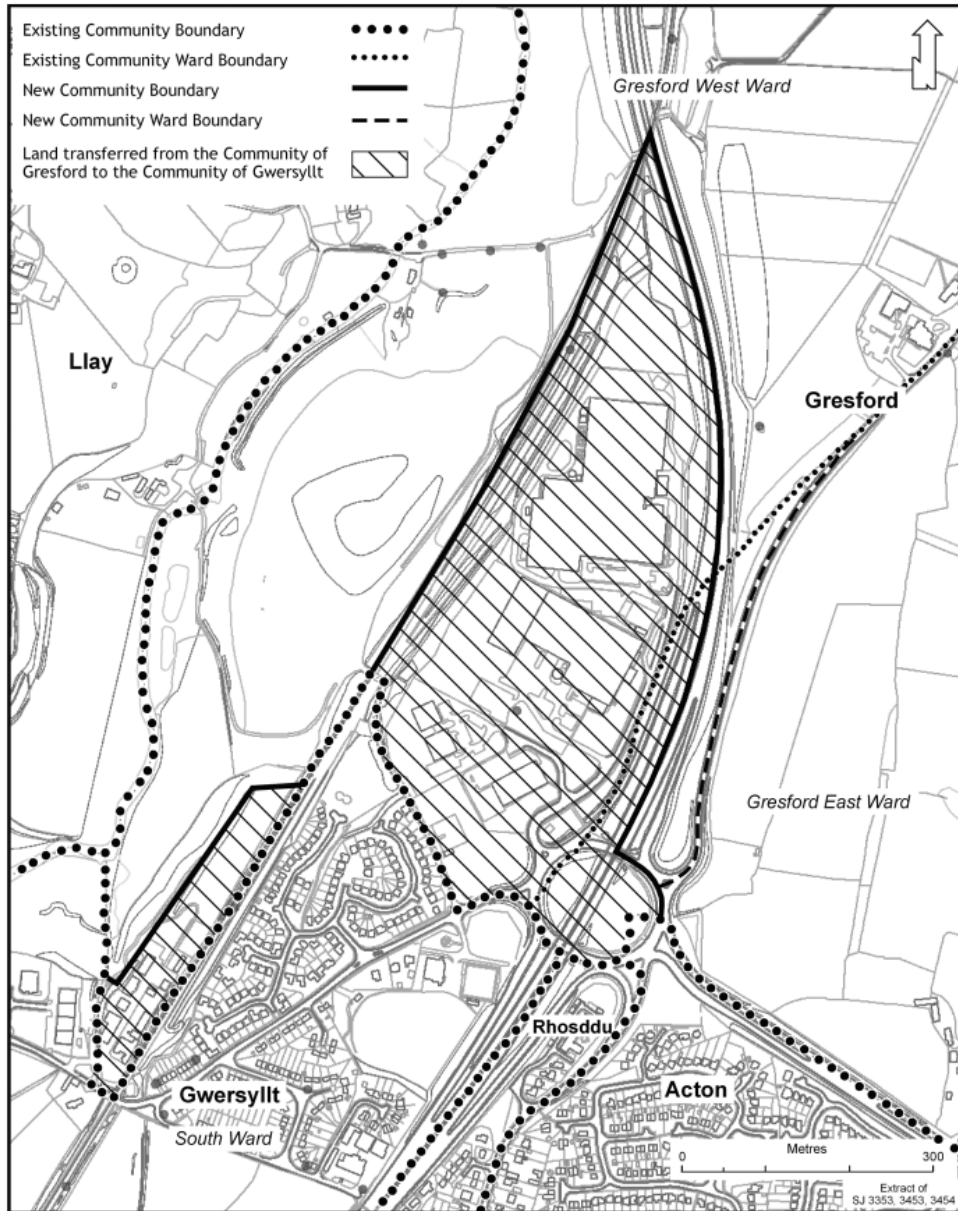

This map is based upon the Ordnance Survey map by the Welsh Assembly Government with the permission of The Controller of Her Majesty's Stationery Office. © Crown copyright 2009. All rights reserved. Unauthorised reproduction infringes Crown copyright and may lead to prosecution or civil proceedings. Licence Number: 100017916

296.08-09e Cartographics
Welsh Assembly Government

Status: This is the original version (as it was originally made). This item of legislation is currently only available in its original format.

Map F of The Wrexham (Communities) Order 2009

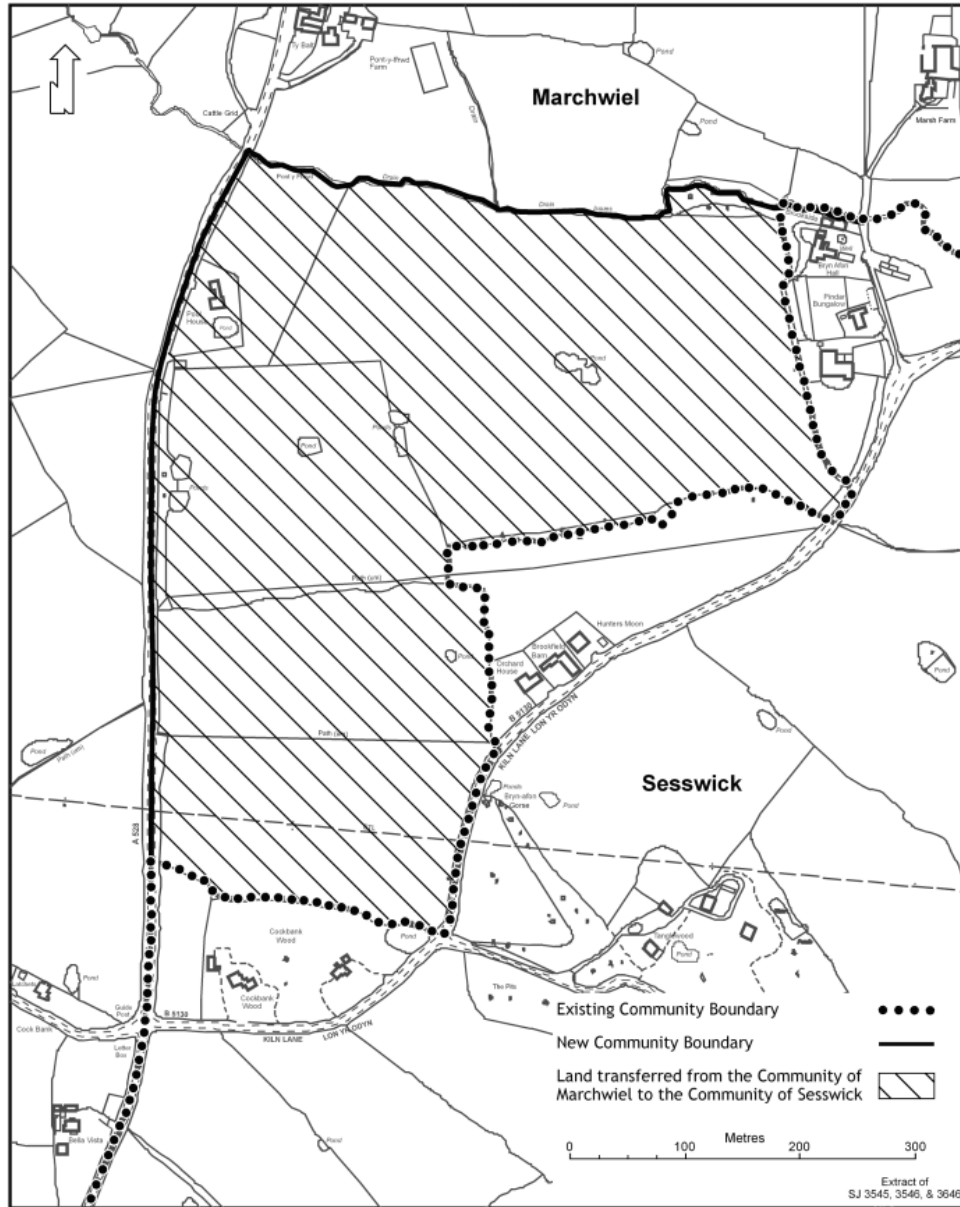

This map is based upon the Ordnance Survey map by the Welsh Assembly Government with the permission of The Controller of Her Majesty's Stationery Office. © Crown copyright 2009. All rights reserved. Unauthorised reproduction infringes Crown copyright and may lead to prosecution or civil proceedings. Licence Number: 100017916

296.08-09 Cartographics
Welsh Assembly Government

Status: This is the original version (as it was originally made). This item of legislation is currently only available in its original format.

Map G of The Wrexham (Communities) Order 2009

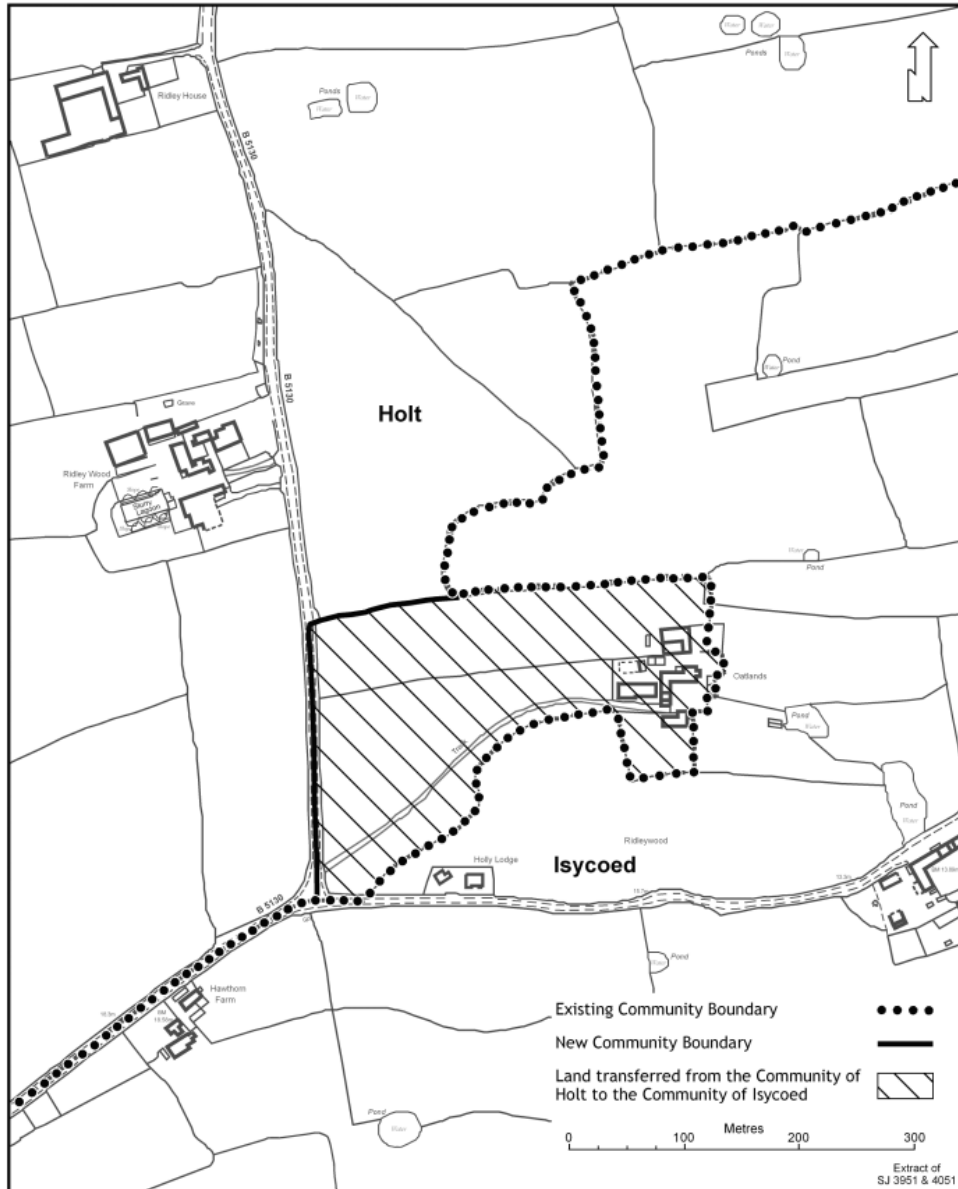

This map is based upon the Ordnance Survey map by the Welsh Assembly Government with the permission of The Controller of Her Majesty's Stationery Office. © Crown copyright 2009. All rights reserved. Unauthorised reproduction infringes Crown copyright and may lead to prosecution or civil proceedings. Licence Number: 100017916

296.08-09 Cartographics
Welsh Assembly Government