STATUTORY INSTRUMENTS

1996 No. 159

HIGHWAYS, ENGLAND AND WALES

**The County Council of Norfolk (Reconstruction
of Acle Wey Bridge—Temporary Bridge)
Scheme 1995 Confirmation Instrument 1996**

Made - - - - 30th January 1996

The Secretary of State for Transport makes this Instrument in exercise of powers conferred by section 106(3) of the Highways Act 1980⁽¹⁾ and now vested in him⁽²⁾ and of all other powers enabling him in that behalf:

1. This Instrument may be cited as “The County Council of Norfolk (Reconstruction of Acle Wey Bridge—Temporary Bridge) Scheme 1995 Confirmation Instrument 1996” and shall come into force on the date on which notice that it has been confirmed is first published in accordance with paragraph 1 of Schedule 2 to the Highways Act 1980.

2. The County Council of Norfolk (Reconstruction of Acle Wey Bridge—Temporary Bridge) Scheme 1995 (“the Scheme”) is hereby confirmed with modifications.

3. The Scheme as confirmed is set out in the Schedule hereto and copies of the Scheme with its accompanying plan are deposited at the offices of the Department of Transport, Great Minster House, 76 Marsham Street, London SW1P 4DR and at the offices of the County Council of Norfolk at County Hall, Martineau Lane, Norwich, NR1 2DH.

Signed by authority of the Secretary of State for Transport

Pamela Denham
Regional Director Government Office for the
North East

30th January 1996

(1) 1980 c. 66.
(2) S.I.1981/238.

Status: This is the original version (as it was originally made). This item of legislation is currently only available in its original format.

THE SCHEDULE

THE COUNTY COUNCIL OF NORFOLK (RECONSTRUCTION OF ACLE WEY BRIDGE—TEMPORARY BRIDGE) SCHEME 1995

The County Council of Norfolk (hereinafter referred to as “the Council”) make this scheme in exercise of their powers under section 106(3) of the Highways Act 1980 and of all other powers enabling them in that behalf:

1. The Council are authorised to construct over the navigable waters of the River Bure the bridge specified in the Schedule to this Scheme as part of the highway which they are proposing to construct between Acle and Fleggburgh in the said County of Norfolk.
2. This Scheme may be cited as the County Council of Norfolk (Reconstruction of Acle Wey Bridge—Temporary Bridge) Scheme 1995.

Given under the Common Seal of the Council

24th July 1995

THE SCHEDULE TO THE SCHEME

PLANS AND SPECIFICATIONS OF ACLE WEY BRIDGE—TEMPORARY BRIDGE

Plans and specifications of the Reconstruction of Acle Wey Bridge—Temporary Bridge are contained in drawing number H2226/EA/3/220/903E annexed hereto.

The County Seal of the Norfolk County Council was hereunto affixed in the presence of:

Assistant Chief Executive & Corporate Solicitor

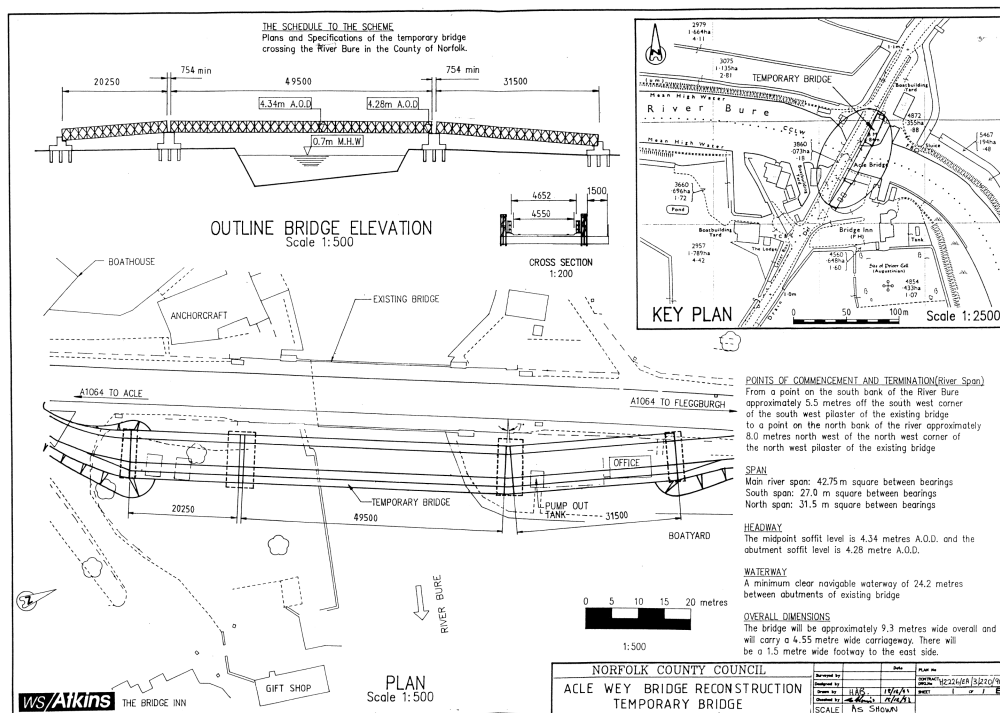

Document Generated: 2023-04-25

Status: *This is the original version (as it was originally made). This item of legislation is currently only available in its original format.*